

BODY PANELS
FOR FIXED HEAD COUPE ONLY
FITTED WITH STANDARD OR OVERDRIVE TRANSMISSION

Part No.	Description	Plate No.	No. per Unit	Remarks
BD.14973	FRONT WING AND VALANCE ASSEMBLY, R.H.		1	L.H. DRIVE CARS ONLY Fitted from Chassis No. 834001 to 834395
BD.12632	Valance Assembly only, R.H.		1	
BD.14974	FRONT WING AND VALANCE ASSEMBLY, R.H.		1	Fitted from Chassis No. 824001 to 824584 834396 to 835718
BD.14169	Valance Assembly only, R.H.		1	
BD.14972	FRONT WING AND VALANCE ASSEMBLY, L.H.		1	Fitted from Chassis No. 824001 to 824584 834001 to 835718
BD.12631	Valance Assembly only, L.H.		1	
BD.14975	FRONT WING AND VALANCE ASSEMBLY, L.H.	C.1	1	} Fitted to Chassis No. 824585 and subs. 835719 and subs.
BD.15311	Valance Assembly only, L.H.		1	
BD.14976	FRONT WING AND VALANCE ASSEMBLY, R.H.	C.2	1	
BD.14169	Valance Assembly only, R.H.		1	
BD.3553	BRACKET FOR ATTACHMENT OF FRONT WING STEADY		1	
UFS.125/SR	Screw, Set, securing Brackets at Battery Box		4	
FW.104/T	Washer, Plain, on Setscrews		8	
UFN.125/L	Nut, on Setscrews		4	
C.724	Washer, Shakeproof, under Nuts		4	
BD.13383	DIAPHRAGM ASSEMBLY BETWEEN L.H. FRONT WING AND DASH SIDE		1	Fitted from Chassis No. 824001 to 824584 834001 to 835718
BD.15037/11	Rubber Seal ($\frac{1}{4}$ " x $1\frac{3}{8}$ " x 39") on Diaphragm		1	

BODY PANELS

FOR FIXED HEAD COUPE ONLY

FITTED WITH STANDARD OR OVERDRIVE TRANSMISSION

Part No.	Description	Plate No.	No. per Unit	Remarks
BD.15121	DIAPHRAGM ASSEMBLY BETWEEN L.H. FRONT WING AND DASH SIDE		1	Fitted to Chassis No. 824585 and subs. 835719 and subs.
BD.15037/11	Rubber Seal ($\frac{1}{4}'' \times 1\frac{3}{8}'' \times 39''$) on Diaphragm		1	
BD.13384	DIAPHRAGM ASSEMBLY BETWEEN R.H. FRONT WING AND DASH SIDE		1	L.H. DRIVE CARS ONLY Fitted from Chassis No. 834001 to 834395
BD.15037/11	Rubber Seal ($\frac{1}{4}'' \times 1\frac{3}{8}'' \times 39''$) on Diaphragm		1	
BD.14227	DIAPHRAGM ASSEMBLY BETWEEN R.H. FRONT WING AND DASH SIDE		1	Fitted to Chassis No. 824001 and subs. 834396 and subs.
BD.15037/11	Rubber Seal ($\frac{1}{4}'' \times 1\frac{3}{8}'' \times 39''$) on Diaphragm		1	
BD.8291/2	Screw, Set, securing Diaphragms to Dash		14	
BD.542/3	Washer, Special, on Setscrews		14	
C.724	Washer, Shakeproof, on Setscrews		14	
BD.12687	FAIRING PANEL, BETWEEN LOWER FORWARD EDGES OF FRONT WINGS	C.3	1	
BD.13407	L.H. PLINTH PANEL ASSEMBLY BEHIND FRONT BUMPER		1	} FITTED TO CARS WITHOUT FOG LAMPS from Chassis No. 824001 to 824096 834001 to 834681
BD.13408	R.H. PLINTH PANEL ASSEMBLY BEHIND FRONT BUMPER		1	

BODY PANELS

FOR FIXED HEAD COUPE ONLY

FITTED WITH STANDARD OR OVERDRIVE TRANSMISSION

Part No.	Description	Plate No.	No. per Unit	Remarks
BD.14838	L.H. PLINTH PANEL ASSEMBLY BEHIND FRONT BUMPER		1	} FITTED TO CARS WITHOUT FOG LAMPS at Chassis No. 824097 and subs. 834682 and subs.
BD.14839	R.H. PLINTH PANEL ASSEMBLY BEHIND FRONT BUMPER		1	
BD.13411	L.H. PLINTH PANEL ASSEMBLY BEHIND FRONT BUMPER		1	} REQUIRED FOR CARS WITH FOG LAMPS at Chassis No. 824097 and subs. 834682 and subs.
BD.13412	R.H. PLINTH PANEL ASSEMBLY BEHIND FRONT BUMPER		1	
BD.8598	Piping, between Plinth Panels and Front Wings (19½" long)		2	
UFS.125/5R	Screw, Set, securing Plinth Panels to Front Wings		6	
FW.104/T	Washer, Plain, on Setscrews		6	
C.8667/1	Nut, Self Locking, on Setscrews		6	
BD.9292	Bracket, for fixing of Plinth Panels to Front Bumper		4	
UFN.125/L	Nut, securing Brackets to Bumper		4	
FW.104/T	Washer, Plain, under Nuts		4	
C.724	Washer, Shakeproof, under Nuts		4	
BD.9301	Bolt, Shouldered, securing Brackets to Plinth Panels		4	
BD.541/13	Washer, Special, on Shouldered Bolts		4	
BD.4984	Washer, Rubber, between Brackets on Bumper and Brackets on Plinth Panels		4	
UFN.119/L	Nut, on Shouldered Bolts		4	
BD.4983	Washer, Special, under Nuts		4	
BD.12543	BONNET ASSEMBLY		1	} Fitted from Chassis No. 824001 to 824584 834001 to 835718
BD.4416	Tapped Plate, for fixing of Bonnet Hinges		2	
UFS.125/4R	Screw, Set, securing Tapped Plates to Bonnet		2	
C.724	Washer, Shakeproof, on Setscrews		2	
FW.104/T	Washer, Plain, under Shakeproof Washers		2	
BD.15379	BONNET ASSEMBLY	C.4	1	} Fitted to Chassis No. 824585 and subs. 835719 and subs.
BD.4416	Tapped Plate, for fixing of Bonnet Hinges		2	
UFS.125/4R	Screw, Set, securing Tapped Plates to Bonnet		2	
FW.104/T	Washer, Plain, on Setscrews		2	
C.724	Washer, Shakeproof, on Setscrews		2	

BODY PANELS

FOR FIXED HEAD COUPE ONLY

FITTED WITH STANDARD OR OVERDRIVE TRANSMISSION

Part No.	Description	Plate No.	No. per Unit	Remarks
BD.5188	DOOR ASSEMBLY FOR VENTILATOR BOXES		2	} Fitted from Chassis No. 824001 to 824584 834001 to 835718
UFN.119/L	Nut, securing Door to Hinge Plates		6	
C.723/A	Washer, Shakeproof, under Nuts		6	
AW.102/T	Washer, Plain, under Shakeproof Washers		6	
BD.5190	SEAL FOR WING VENTILATOR DOORS		2	} Fitted from Chassis No. 824001 to 824584 834001 to 835718
BD.5189	GAUZE ASSEMBLY FOR WING VENTILATOR DOORS		2	
BD.711/6	Screw, Self Tapping, securing Gauze Assemblies		4	
BD.14724	OUTER DOOR ASSEMBLY ON VENTILATOR BOXES IN FRONT WINGS	C.5	2	
UFN.125/L	Nut, securing Doors to Ventilator Boxes		8	} Fitted to Chassis No. 824585 and subs. 835719 and subs.
C.724	Washer, Shakeproof, under Nuts		8	
FW.104/T	Washer, Plain, under Shakeproof Washers and adjacent to Doors		16	
BD.14667	GAUZE ASSEMBLY FOR OUTER DOORS		2	
BD.540/9	Screw, Self Tapping, securing Gauzes		8	} Fitted to Chassis No. 824585 and subs. 835719 and subs.
BD.16091	RUBBER SEAL FOR VENTILATOR DOORS		2	

BODY PANELS

FOR FIXED HEAD COUPE ONLY

FITTED WITH STANDARD OR OVERDRIVE TRANSMISSION

Part No.	Description	Plate No.	No. per Unit	Remarks
BD.15562	DOOR SHELL ASSEMBLY, L.H.	C.6	1	
BD.15563	DOOR SHELL ASSEMBLY, R.H.	C.7	1	
BD.15564	Hinge Pillar Assembly, for L.H. Door		1	
BD.15565	Hinge Pillar Assembly, for R.H. Door		1	
BD.12623	Shut Pillar Assembly, for L.H. Door		1	
BD.12624	Shut Pillar Assembly, for R.H. Door		1	
BD.14901	Striker, for Interior Light Switch		2	
BD.539/15	Screw, Self Tapping, securing Strikers		4	
BD.12796	Outer Panel Assembly, for L.H. Door		1	
BD.12797	Outer Panel Assembly, for R.H. Door		1	
BD.15566	Guide Spring, for Check Arms		2	
BD.15569/1	Rivet, securing Guide Springs		4	
BD.15752	Reinforcement Assembly, for Hinge Pillar in L.H. Door		1	
BD.15753	Reinforcement Assembly, for Hinge Pillar in R.H. Door		1	
BD.13137	Seal Plate, at bottom of Door Shut Pillars		2	
BD.14008	Insert (Hardwood) under Sealing Plates		2	
BD.539/12	Screw, Self Tapping, securing Sealing Plates		4	
BD.12526	Stiffener Assembly, in L.H. Door		1	
BD.12527	Stiffener Assembly, in R.H. Door		1	
UFS.125/4R	Screw, Set, securing Stiffeners		4	
C.724	Washer, Shakeproof, on Setscrews		4	
FW.104/T	Washer, Plain, under Shakeproof Washers		4	
BD.12734	Felt, behind Stiffeners (4" x 37")		2	
BD.12769	Garnish Rail Assembly, in L.H. Door		1	
BD.12770	Garnish Rail Assembly, in R.H. Door		1	
BD.12524	Bottom Panel, for L.H. Door		1	
BD.12525	Bottom Panel, for R.H. Door		1	
BD.14894	Reinforcement Plate Assembly, complete with Screwed Rod, for fixing of Armrests		2	
UFS.125/8R	Screw, Set, securing Doors to Swing Arms		16	
C.724	Washer, Shakeproof, on Setscrews		16	
BD.16155/1	Shim, between Doors and Swing Arms (20 S.W.G.)		As req'd	
BD.16155/2	Shim, between Doors and Swing Arms (16 S.W.G.)		As req'd	
BD.14923	CHECK ARM ASSEMBLY FOR DOORS (WB.7/5040/2)		2	
BD.14933	Pin, securing Check Arms to Brackets on Hinge Face Panels		2	
BD.847	Washer, Brass, on Pins		4	
L.102/4U	Split Pin, retaining Pins		2	
BD.19916	WINDSCREEN APERTURE PANEL ASSEMBLY	C.8	1	

BODY PANELS

FOR FIXED HEAD COUPE ONLY

FITTED WITH STANDARD OR OVERDRIVE TRANSMISSION

Part No.	Description	Plate No.	No. per Unit	Remarks
BD.12549	CANOPY PANEL ASSEMBLY	C.9	1	
BD.12530	L.H. REAR WING ASSEMBLY		1	} REQUIRED WHEN DISC TYPE ROAD WHEELS ARE FITTED.
BD.12531	R.H. REAR WING ASSEMBLY		1	
BD.4451	Striker Plate, on Rear Wings		2	
BD.4442	Swivel Rod, on Rear Wings		4	
BD.11178	Sealing Rubber, around Wheel Aperture on Rear Wings (54" long)		2	
BD.13379	L.H. REAR WING ASSEMBLY	C.10	1	} REQUIRED WHEN WIRE SPOKE ROAD WHEELS ARE FITTED.
BD.13380	R.H. REAR WING ASSEMBLY	C.11	1	
BD.7769	Moulding, around Wheel Aperture in L.H. Rear Wing		1	
BD.7770	Moulding, around Wheel Aperture in R.H. Rear Wing		1	
BD.1814/1	Pop Rivet, securing Mouldings		32	
BD.4449	COVER ASSEMBLY FOR L.H. REAR WING		1	} FOR USE WHEN DISC TYPE ROAD WHEELS ARE FITTED.
BD.4450	COVER ASSEMBLY FOR R.H. REAR WING		1	
BD.2121	Lock, on L.H. Cover (WB.12288/A)		1	
BD.2122	Lock, on R.H. Cover (WB.12288/B)		1	
UFS.519/4H	Screw, Set, securing Locks		4	
UFN.119/L	Nut, on Setscrews		4	
C.723/A	Washer, Shakeproof, under Nuts		4	

BODY PANELS

FOR FIXED HEAD COUPE ONLY

FITTED WITH STANDARD OR OVERDRIVE TRANSMISSION

Part No.	Description	Plate No.	No. per Unit	Remarks
2312	ESCUTCHEON FOR REAR WING COVER (WB.16049)		2	} REQUIRED WHEN DISC TYPE ROAD WHEELS ARE FITTED.
BD.540/9	Screw, Self Tapping, securing Escutcheons		4	
BD.8598	PIPING BETWEEN REAR WINGS AND BODY (72" LONG)		2	
BD.539/18	Screw, Self Tapping, securing Rear Wings to Body		18	
BD.541/13	Washer, Special, on Self Tapping Screws		14	
UFN.125/L	Nut, securing Rear Wings to Body at front		12	
BD.542/3	Washer, Special, under Nuts		12	
C.724	Washer, Shakeproof, under Nuts		12	
BD.13565/2	Screw, Set, securing Rear Wings to Body ($\frac{3}{4}$ " long)		10	
BD.13565/4	Screw, Set, securing Rear Wings to Body (1" long)		4	
C.725	Washer, Shakeproof, on Setscrews		14	
BD.542/2	Washer, Special, under Shakeproof Washers		14	
BD.6194	STEADY ASSEMBLY FOR L.H. REAR WING		1	
BD.6195	STEADY ASSEMBLY FOR R.H. REAR WING		1	
UFN.131/L	Nut, securing Steadies to Chassis and Wings		6	
C.725	Washer, Shakeproof, under Nuts		6	
BD.14487	REAR END ASSEMBLY		1	Fitted from Chassis No. 824001 to 824584 834001 to 835718
BD.12502	Tonneau Panel Assembly		1	
BD.14096	Sill Assembly, L.H.		1	
BD.14097	Sill Assembly, R.H.		1	
BD.19843	Rear Seat Panel Assembly (PG.2072)		1	
BD.12653	Wheel Arch Assembly, L.H.		1	
BD.12654	Wheel Arch Assembly, R.H.		1	
BD.12504	Face Panel Assembly, for L.H. Shut Pillar		1	
BD.12505	Face Panel Assembly, for R.H. Shut Pillar		1	
BD.13057	Sealing Plate Assembly, for L.H. Shut Pillar		1	
BD.13058	Sealing Plate Assembly, for R.H. Shut Pillar		1	
BD.9300	Fixed Floor Assembly		1	
BD.14907	Boot Lid Shell Assembly		1	
BD.9326	Tray Assembly, holding Spare Wheel		1	

BODY PANELS

FOR FIXED HEAD COUPE ONLY

FITTED WITH STANDARD OR OVERDRIVE TRANSMISSION

Part No.	Description	Plate No.	No. per Unit	Remarks
BD.15801	REAR END ASSEMBLY		1	Fitted to Chassis No. 824585 and subs. 835719 and subs.
BD.15803	Tonneau Panel Assembly		1	
BD.15782	Wheel Arch Assembly, L.H.		1	
For all other items, please refer to Rear End Assembly BD.14487				
BD.12502	TONNEAU PANEL ASSEMBLY		1	Fitted from Chassis No. 824001 to 824584 834001 to 835718
BD.12593	Top Panel, for Tonneau		1	
BD.12666	L.H. Panel, for Tonneau		1	
BD.12667	R.H. Panel, for Tonneau		1	
BD.12668	Panel Assembly, lower, for Tonneau		1	
BD.12886	Bottom Panel, for Tonneau		1	
BD.12651	Gutter Assembly, around Luggage Compartment Lid Aperture		1	
BD.12503	Cross Member Assembly, for Tonneau		1	
BD.8928	Parcel Tray Assembly		1	
BD.15803	TONNEAU PANEL ASSEMBLY	C.12	1	Fitted to Chassis No. 824585 and subs. 835719 and subs.
BD.15796	L.H. Panel, for Tonneau		1	
BD.16033	R.H. Panel, for Tonneau		1	
BD.16963	Cross Member Assembly, for Tonneau		1	
BD.8928	Parcel Tray Assembly		1	Fitted from Chassis No. 824585 to 824676 835719 to 835892
BD.16043	Parcel Tray Assembly		1	Fitted to Chassis No. 824677 and subs. 835893 and subs.
For all other items, please refer to Tonneau Panel Assembly BD.12502				
BD.14907	BOOT LID SHELL ASSEMBLY	C.13	1	
BD.16797	Mounting Bracket Assembly, for L.H. Hinge		1	
BD.16798	Mounting Bracket Assembly, for R.H. Hinge		1	
M.108/6R	Woodscrew, securing Mounting Brackets		16	
BD.17389	Reinforcement Angle, on second rail		1	
M.108/6R	Woodscrew, securing Reinforcement Angle		6	
UFS.125/4R	Screw, Set, securing Boot Lid to Hinge Arms		2	
UFS.125/5R	Screw, Set, securing Boot Lid to Hinge Arms		4	
FW.104/T	Washer, Plain, on Setscrews		4	
BD.541/9	Washer, Special, on Setscrews		6	
C.724	Washer, Shakeproof, on Setscrews		6	
BD.16784	Packing, at Hinge fixing		As req'd	

BODY PANELS
FOR FIXED HEAD COUPE ONLY
FITTED WITH STANDARD OR OVERDRIVE TRANSMISSION

Part No.	Description	Plate No.	No. per Unit	Remarks
BD.9397	PETROL FILLER BOX ASSEMBLY		1	Fitted from Chassis No. 824001 to 824452 834001 to 835588
BD.15613	PETROL FILLER BOX ASSEMBLY		1	Fitted from Chassis No. 824453 to 824584 835589 to 835718
BD.9489	SNAPSAC SLEEVE, ON PETROL FILLER BOX, FOR LOCK STRIKER		1	} Fitted from Chassis No. 824001 to 824584 834001 to 835718
BD.4368	Hose, connecting Filler Box to Petrol Tank		1	
C.2905/7	Clip, securing Hose		2	
BD.4369	Extension Tube (Rubber) for Drain Pipe on Filler Box		1	
C.5574	Grommet, in Wheel Arch Panel, for Extension Tube		1	
BD.4357	DOOR ASSEMBLY FOR PETROL FILLER BOX		1	} Fitted from Chassis No. 824001 to 824584 834001 to 835718
UFN.119/L	Nut, securing Door to Hinges		4	
C.723/A	Washer, Shakeproof, under Nuts		4	
AW.102/T	Washer, Plain, under Shakeproof Washers		4	
BD.4354	Rubber Seal, around Filler Box aperture, seating Door		1	
BD.4360	LOCK ASSEMBLY FOR PETROL FILLER DOOR		1	} Fitted from Chassis No. 824001 to 824584 834001 to 835718
BD.8071	Spring Clip, securing Lock to Door (WB.7/4098)		1	
BD.4353	STRIKER ASSEMBLY FOR PETROL FILLER LOCK		1	} Fitted from Chassis No. 824001 to 824584 834001 to 835718
BD.10641	Stud Plate Assembly, for fixing of Striker inside Petrol Filler Box		1	
UFN.119/L	Nut, securing Stud Plate and Striker		2	
C.723/A	Washer, Shakeproof, under Nuts		2	
AW.102/T	Washer, Plain, under Shakeproof Washers		2	

BODY PANELS

FOR FIXED HEAD COUPE ONLY

FITTED WITH STANDARD OR OVERDRIVE TRANSMISSION

Part No.	Description	Plate No.	No. per Unit	Remarks	
BD.4358	HINGE ASSEMBLY FOR PETROL FILLER DOOR		1	} Fitted from Chassis No. 824001 to 824584 834001 to 835718	
BD.4366	Spring only, for Hinge		1		
UFS.319/3H C.723/A	Screw, Set, securing Hinge inside Petrol Filler Box Washer, Shakeproof, on Setscrews		2 2		
BD.3699	FILLER CAP ON HINGE		1		
BD.3189	Cork Seal, Inside Filler Cap		1		
BD.4394	Spring, between Filler Cap and Hinge		1		
L.102/4U	Split Pin, securing Filler Cap to Hinge		1		
C.2501/3	Washer, Plain, under Split Pin		1		
BD.15735	PETROL FILLER BOX ASSEMBLY		1		Fitted to Chassis No. 824585 and subs. 835719 and subs.
BD.4368	Hose, connecting Filler Box to Tank		1		
C.2905/7	Clip, securing Hose to Tank and Filler Box		2		
BD.4369	Extension Tube (Rubber) for Drain Pipe on Filler Box		1		
C.5574	Grommet, in Wheel Arch Panel, for Extension Tube		1		
BD.15743	DOOR ASSEMBLY FOR PETROL FILLER BOX	C.14	1	Fitted to Chassis No. 824585 and subs. 835719 and subs.	
BD.4366	Spring, for Hinge		1		
BD.4394	Spring, on Petrol Cap		1		
BD.8082	Plate, retaining Spring (253/278)		1		
L.102/4U	Split Pin, securing Plate		1		
C.2501/3	Washer, Plain, under Split Pin		1		
BD.8076	Rubber Cup, on Spring retaining Plate		1		
BD.9278	Rubber Insert, for Cup		1		
BD.16257/2	Screw, Set, securing Door Assembly to Petrol Filler Box		2		
C.723/A	Washer, Shakeproof, on Setscrews		2		
BD.9184	CATCH BRACKET ASSEMBLY IN PETROL FILLER BOX (WB.7/9183)		1	Fitted to Chassis No. 824585 and subs. 835719 and subs.	
BD.16257/2	Screw, Set, securing Catch Bracket to Filler Box		2		
C.723/A	Washer, Shakeproof, on Setscrews		2		
AW.102/T	Washer, Plain, under Shakeproof Washers		2		

BODY PANELS

FOR FIXED HEAD COUPE ONLY

FITTED WITH STANDARD OR OVERDRIVE TRANSMISSION

Part No.	Description	Plate No.	No. per Unit	Remarks
BD.16256	LOCK, IN PETROL FILLER DOOR (WB.7/23023)		1	Fitted to Chassis No. 824585 and subs. 835719 and subs.
BD.8071	Spring Clip, securing Lock		1	
BD.4321	Rubber Buffer, in Petrol Filler aperture, cushioning Door		2	
BD.12800	COVER PLATE, OVER PETROL FILLER PIPE		1	Fitted from Chassis No. 824001 to 824584 834001 to 835718
BD.15811	COVER PLATE, OVER PETROL FILLER PIPE		1	Fitted to Chassis No. 824585 and subs. 835719 and subs.
BD.9584	Rubber Seal, under Cover Plates		1	
BD.539/17	Screw, Self Tapping, securing Cover Plates		4	
BD.12503	CROSS MEMBER ASSEMBLY FOR TONNEAU		1	Fitted from Chassis No. 824001 to 824676 834001 to 835892
BD.13360	Bracket Assembly, for Boot Lid L.H. Hinge		1	
BD.13361	Bracket Assembly, for Boot Lid R.H. Hinge		1	
BD.12831	Arm Assembly, for Boot Lid Hinges		2	
BD.13363	Pin, hinging Boot Lid		2	
C.724	Washer, Shakeproof, on Pins		2	
UFN.225/L	Nut, on Hinge Pins		4	
UFS.125/4R	Screw, Set, securing Hinge Brackets		16	
FW.104/T	Washer, Plain, on Setscrews		12	
BD.4332	Bridge Piece, at upper fixing		2	
C.724	Washer, Shakeproof, under Nuts		16	
BD.16963	CROSS MEMBER ASSEMBLY FOR TONNEAU		1	Fitted to Chassis No. 824677 and subs. 835893 and subs.
BD.16579	Tapped Plate, on Cross Member for fixing of Boot Lid Hinges		4	
BD.8928	PARCEL TRAY ASSEMBLY ABOVE REAR SEATS		1	Fitted from Chassis No. 824001 to 824676 834001 to 835892

BODY PANELS

FOR FIXED HEAD COUPE ONLY

FITTED WITH STANDARD OR OVERDRIVE TRANSMISSION

Part No.	Description	Plate No.	No. per Unit	Remarks
BD.16043	PARCEL TRAY ASSEMBLY ABOVE REAR SEATS		1	Fitted to Chassis No. 824677 and subs. 835893 and subs.
BD.9491	Reinforcement Panel, at L.H. end of Parcel Tray		1	
BD.9492	Reinforcement Panel, at R.H. end of Parcel Tray	D.1	1	
BD.17733	L.H. HINGE ASSEMBLY FOR BOOT LID		1	} Fitted from Chassis No. 824677 to 824862 835893 to 836183
BD.17734	R.H. HINGE ASSEMBLY FOR BOOT LID	D.2	1	
BD.16085	Spring, for Boot Lid Hinges (WB.7/9464)		4	
BD.15711	Pin, anchoring Boot Lid Hinge Springs		2	
BD.15712	Roller, on Pins		2	
L.104/12U	Split Pin, retaining Springs on Support Brackets		4	
BD.15714	Washer, under Split Pins		4	
L.104/7U	Split Pin, retaining Spring on Anchor Pins		4	
BD.15717	Washer, under Split Pins		4	
BD.16690	Tapped Plate, for fixing of Boot Lid Hinges (4½" long)		2	
BD.16691	Tapped Plate, for fixing of Boot Lid Hinges (4" long)		2	
UFS.125/4R	Screw, Set, securing Hinge Assemblies to Cross Member		16	
C.724	Washer, Shakeproof, on Setscrews		16	
BD.16245	L.H. HINGE ASSEMBLY FOR BOOT LID		1	} Fitted to Chassis No. 824863 and subs. 836184 and subs.
BD.16246	R.H. HINGE ASSEMBLY FOR BOOT LID	D.2	1	
	For replaceable items, please refer to Hinge Assemblies BD.17733/4			
BD.16713	RUBBER BUFFER, CUSHIONING HINGE ARMS WHEN BOOT LID IS OPEN		2	Fitted to Chassis No. 824863 and subs. 836184 and subs.
BD.16717	Fixing Plate, for securing of Rubber Buffers		2	
BD.14399/1	Screw, Set, securing Rubber Buffers to Cross Member, through Fixing Plates		2	
C.723/A	Washer, Shakeproof, on Setscrews		2	
BD.541/28	Washer, Plain, under Shakeproof Washers		2	

BODY PANELS

FOR FIXED HEAD COUPE ONLY

FITTED WITH STANDARD OR OVERDRIVE TRANSMISSION

Part No.	Description	Plate No.	No. per Unit	Remarks
BD.9300	FIXED FLOOR ASSEMBLY	D.3	1	
BD.6244	Tapped Plates , for attachment of Seat Slides		4	
UFS.525/5H	Screw , Set, securing Tapped Plates to underside of Floor		8	
BD.9409	Asbestos Sheet , under Fixed Floor		2	
BD.9410	Retaining Plate , for Asbestos Sheets		2	
BD.524/7	Bifurcated Rivet , securing Asbestos Sheets and Plates to Floor		22	
BD.19843	REAR SEAT PANEL ASSEMBLY (PG.2072)	D.4	1	
BD.13932	Panel Assembly , forward Boot Floor		1	
BD.9006	Asbestos Pad , on Panel, for Heat Insulation from Exhaust System		1	
BD.9010	Asbestos Pad , on Panel, for Heat Insulation from Exhaust System		1	
BD.9021	Retaining Plate , for Asbestos Insulation		1	
BD.9022	Retaining Plate , for Asbestos Insulation		1	
BD.524/6	Bifurcated Rivet , securing Plates and Asbestos to Panels		14	
BD.9023	Cover Plate , over Aperture in L.H. Seat Panel		1	
BD.538/5	Screw , Self Tapping, securing Cover Plate		6	
BD.9005	Asbestos Disc , under Cover Plate		1	
BD.9020	Retaining Plate , for Asbestos Disc		1	
BD.524/6	Bifurcated Rivet , securing Asbestos Disc and Retaining Plate to Cover Plate		3	
BD.9326	TRAY ASSEMBLY, HOLDING SPARE WHEEL	D.5	1	
BD.12654	R.H. WHEEL ARCH ASSEMBLY		1	
BD.12656	Panel , for R.H. Wheel Arch		1	
BD.12664	Butt Strap , for Wheel Arch		1	
BD.8681	Clip , for Electrical Wiring		5	
BD.9312	Support Assembly , at rear of R.H. Wheel Arch		1	
BD.12653	L.H. WHEEL ARCH ASSEMBLY		1	Fitted from Chassis No. 824001 to 824584 834001 to 835718
BD.12655	Panel , for L.H. Wheel Arch		1	
BD.8681	Clip , for Electrical Wiring		4	
BD.9311	Support Assembly , at rear of L.H. Wheel Arch		1	
BD.12664	Butt Strap , for Wheel Arch		1	

BODY PANELS

FOR FIXED HEAD COUPE ONLY

FITTED WITH STANDARD OR OVERDRIVE TRANSMISSION

Part No.	Description	Plate No.	No. per Unit	Remarks
BD.15782	L.H. WHEEL ARCH ASSEMBLY	D.6	1	Fitted to Chassis No. 824585 and subs. 835719 and subs.
BD.15780	Panel, for L.H. Wheel Arch		1	
	For other items, please refer to L.H. Wheel Arch Assembly BD.12653			
C.5647	RUBBER PLUG, SEALING ACCESS HOLES IN WHEEL ARCHES		4	
BD.14096	L.H. DOOR SILL ASSEMBLY	D.7	1	
BD.14097	R.H. DOOR SILL ASSEMBLY		1	
BD.14073	Outer Panel, for L.H. Door Sill		1	
BD.14074	Outer Panel, for R.H. Door Sill		1	
BD.14098	Inner Panel Assembly, for L.H. Door Sill		1	
BD.14099	Inner Panel Assembly, for R.H. Door Sill		1	
BD.4107	Reinforcing Plate, for Sill mountings		4	
BD.7723	Mounting Bracket, for Sills		4	
BD.13901	Mounting Bracket Assembly, for Dash, L.H.		1	
BD.13902	Mounting Bracket Assembly, for Dash, R.H.		1	
BD.12726	Shut Pillar Assembly, L.H.		1	
BD.12727	Shut Pillar Assembly, R.H.		1	
BD.10158	Retainer, on side of Sills, for Door Seals		2	
BD.13056	Retainer, at top of Sills, for Draught Excluders		2	
BD.1814/2	Pop Rivet, securing Retainers		28	
UFS.137/8R	Screw, Set, securing Sills to Dash		12	
C.726	Washer, Shakeproof, on Setscrews		12	
FW.106/T	Washer, Plain, under Shakeproof Washers		12	
BD.10078	SEALING PLATE ASSEMBLY, BETWEEN SILL AND L.H. FRONT WING		1	
BD.10705	SEALING PLATE ASSEMBLY, BETWEEN SILL AND R.H. FRONT WING		1	
BD.711/18	Screw, Self Tapping, securing Sealing Plates		8	

BODY PANELS
FOR FIXED HEAD COUPE ONLY
FITTED WITH STANDARD OR OVERDRIVE TRANSMISSION

Part No.	Description	Plate No.	No. per Unit	Remarks
BD.12504	FACE PANEL ASSEMBLY FOR L.H. SHUT PILLAR	D.8	1	
BD.12505	FACE PANEL ASSEMBLY FOR R.H. SHUT PILLAR		1	
BD.16129	Tapped Plate, for fixing of Door Lock Strikers		2	
BD.16126	Retainer, on L.H. Shut Pillar for Tapped Plate		1	
BD.16127	Retainer, on R.H. Shut Pillar for Tapped Plate		1	
BD.13800	STRIKER ASSEMBLY FOR L.H. DOOR LOCK (WB.3/4801/1)	D.9	1	
BD.13801	STRIKER ASSEMBLY FOR R.H. DOOR LOCK (WB.3/4802/1)		1	
BD.10930	Packing, under Strikers (18 S.W.G.)		As req'd	
BD.14670/2	Screw, Set, securing Strikers		4	
BD.13802	STRIKING PLATE FOR L.H. DOOR LOCK (WB.3-9290/0)	D.10	1	
BD.13803	STRIKING PLATE FOR R.H. DOOR LOCK (WB.3-9291/0)		1	
BD.13057	SEALING PLATE ASSEMBLY FOR L.H. SHUT PILLAR		1	
BD.13058	SEALING PLATE ASSEMBLY FOR R.H. SHUT PILLAR		1	
BD.15037/2	Seal (Sponge Rubber $\frac{1}{4} \times 1\frac{3}{8} \times 3\frac{1}{4}$) on Sealing Plates		2	
BD.15037/10	Seal (Sponge Rubber $\frac{1}{4} \times 1\frac{3}{8} \times 28\frac{1}{2}$) on Sealing Plates		2	
BD.8691/3	Screw, Self Tapping, securing Sealing Plates at side		8	
BD.711/9	Screw, Self Tapping, securing Sealing Plates at bottom		6	
AW.102/T	Washer, Plain, on Self Tapping Screws		14	

BODY PANELS

FOR FIXED HEAD COUPE ONLY

FITTED WITH STANDARD OR OVERDRIVE TRANSMISSION

Part No.	Description	Plate No.	No. per Unit	Remarks
BD.15570	SWING ARM, MOUNTING DOORS TO BODY	D.11	4	
UFB.131/11R	Bolt , through Mounting Plates, pivoting Swing Arms		4	
BD.13207	Bush (Steel), on Bolts		4	
C.8667/2	Nut , Self Locking, on Bolts		4	
FW.105/T	Washer , Plain, under Nuts		4	
BD.14396	HINGE FACE PANEL, L.H.	D.12	1	
BD.14397	HINGE FACE PANEL, R.H.		1	
BD.12549	CANOPY PANEL ASSEMBLY		1	
BD.13135	Drip Rail , at L.H. side of Canopy		1	
BD.13136	Drip Rail , at R.H. side of Canopy		1	
BD.1814/2	Pop Rivet , securing Drip Rails to Canopy		42	
BD.1814/7	Pop Rivet , securing Drip Rails to Screen Pillars		16	
BD.12621	Surround Panel , upper, for Backlight	D.13	2	
BD.12622	Surround Panel , lower, for Backlight		1	Fitted from Chassis No. 824001 to 824676 834001 to 835892
BD.16025	Surround Panel Assembly , lower, for Backlight	D.14	1	Fitted to Chassis No. 824677 and subs. 835893 and subs.
BD.13955	QUARTER PANEL ABOVE L.H. WHEEL ARCH		1	
BD.13956	QUARTER PANEL ABOVE R.H. WHEEL ARCH	D.15	1	

BODY PANELS

FOR FIXED HEAD COUPE ONLY

FITTED WITH STANDARD OR OVERDRIVE TRANSMISSION

Part No.	Description	Plate No.	No. per Unit	Remarks
BD.12750	HINGE ASSEMBLY, FOR BONNET		2	} Fitted from Chassis No. 824001 to 824584 834001 to 835718
BD.10709	Tapped Plate , for fixing of Hinges to Dash		4	
NS.125/4D	Screw, Set , securing Hinges to Bonnet and Dash		16	
C.724	Washer , Shakeproof, on Setscrews		16	
FW.104/T	Washer , Plain, under Shakeproof Washers		16	
BD.10707	Shim , for Bonnet Hinges		As req'd	
BD.14882	HINGE ASSEMBLY, FOR BONNET	D.16	2	} Fitted to Chassis No. 824585 and subs. 835719 and subs.
BD.14886	Bracket Assembly , behind Dash Top Panel, for fixing of Bonnet Hinges		2	
UFS.125/4R	Screw, Set , securing Hinges to Dash and Bonnet		16	
FW.104/T	Washer , Plain, on Setscrews		16	
C.724	Washer , Shakeproof, on Setscrews		16	
BD.10707	Shim , packing Bonnet Hinges		As req'd	
BD.5183	VENTILATOR BOX ASSEMBLY IN L.H. FRONT WING		1	} Fitted from Chassis No. 824001 to 824584 834001 to 835718
BD.5184	VENTILATOR BOX ASSEMBLY IN R.H. FRONT WING		1	
BD.5127	Hinge Assembly , on L.H. Ventilator Box		1	
BD.5128	Hinge Assembly , on R.H. Ventilator Box		1	
BD.648	Spring Plunger , on Hinges		2	
R.303/5W	Rivet , securing Plungers		2	
C.3350	Brass Washer , at each side of Plunger		4	
BD.650	Loose Head , for end of Rivets		2	
UFS.519/3H	Screw, Set , securing Hinges to Ventilator Boxes		6	
UFN.119/L	Nut , on Setscrews		6	
AG.102/X	Washer , Spring, under Nuts		6	
BD.5176	Spring , for Ventilator Doors		2	
BD.5125	Sleeve , housing Springs		2	
L.104/10U	Split Pin , securing Sleeves		2	
C.3571	Shim , adjusting Spring Tension		As req'd	
BD.3712/1	Adjusting Plate , between Hinge and Door (.064" thick)		As req'd	
BD.3712/2	Adjusting Plate , between Hinge and Door (.048" thick)		As req'd	
BD.3712/3	Adjusting Plate , between Hinge and Door (.036" thick)		As req'd	
BD.3712/4	Adjusting Plate , between Hinge and Door (.022" thick)		As req'd	

BODY PANELS

FOR FIXED HEAD COUPE ONLY

FITTED WITH STANDARD OR OVERDRIVE TRANSMISSION

Part No.	Description	Plate No.	No. per Unit	Remarks
BD.14646	VENTILATOR BOX ASSEMBLY IN L.H. FRONT WING	D.17	1	Fitted to Chassis No. 824585 and subs. 835719 and subs.
BD.14651	Mounting Plate Assembly, for Outer Door		1	
UFS.519/3H	Screw, Set, securing Mounting Plate to Ventilator Box		5	
UFN.119/L	Nut, on Setscrews		5	
C.723/A	Washer, Shakeproof, under Nuts		5	
BD.15431	Operating Lever, for Ventilator		1	
UFS.519/3H	Screw, Set, securing Operating Lever		2	
UFN.119/L	Nut, on Setscrews		2	
C.723/A	Washer, Shakeproof, under Nuts		2	
BD.4616	Rubber Buffer, cushioning Operating Lever		2	
BD.14725	Spring, between top of Mounting Plate and Ventilator Box		1	
BD.14792	Spring, between bottom of Mounting Plate and Ventilator Box		1	
BD.16339	Attachment Plate, for fixing of Ventilator Box to Body Interior		1	
BD.711/3	Screw, Self Tapping, securing Attachment Plate to Box		4	
BD.711/2	Screw, Self Tapping, securing Ventilator Box to Body		7	
BD.711/1	Screw, Self Tapping, securing Ventilator Box to Wing		6	
BD.14730	VENTILATOR BOX ASSEMBLY IN R.H. FRONT WING		1	Fitted to Chassis No. 824585 and subs. 835719 and subs.
BD.14735	Mounting Plate Assembly, for Outer Door		1	
UFS.519/3H	Screw, Set, securing Mounting Plate		5	
UFN.119/L	Nut, on Setscrews		5	
C.723/A	Washer, Shakeproof, under Nuts		5	
BD.15430	Operating Lever, in Ventilator Door		1	
UFS.519/3H	Screw, Set, securing Operating Lever		2	
UFN.119/L	Nut, on Setscrews		2	
C.723/A	Washer, Shakeproof, under Nuts		2	
BD.4616	Rubber Buffer, cushioning Operating Lever		2	
BD.14726	Spring, between bottom of Mounting Plate and Ventilator Box		1	
BD.14792	Spring, between top of Mounting Plate and Ventilator Box		1	
BD.711/1	Screw, Self Tapping, securing Ventilator Box to Wing		6	
BD.711/2	Screw, Self Tapping, securing Ventilator Box to Body Interior		7	
BD.14166	DASH ASSEMBLY, COMPLETE		1	FITTED TO R.H. DRIVE CARS from Chassis No. 824001 to 824584
BD.16189	Mounting Plate Assembly, for Door Swing Arms		4	
UFS.125/5R	Screw, Set, securing Mounting Plates		32	
C.724	Washer, Shakeproof, on Setscrews		32	
UFN.125/L	Nut, on Setscrews		24	
BD.4555	Shim, for bottom Mounting Plates		As req'd	

BODY PANELS
FOR FIXED HEAD COUPE ONLY
FITTED WITH STANDARD OR OVERDRIVE TRANSMISSION

Part No.	Description	Plate No.	No. per Unit	Remarks
BD.14262	DASH ASSEMBLY, COMPLETE For individual items, please refer to Dash Assembly BD.14166		1	FITTED TO R.H. DRIVE CARS from Chassis No. 824585 to 824904 NO LONGER SUPPLIED. USE DASH ASSEMBLY BD.16847 FOR SERVICE PURPOSES.
BD.16847	DASH ASSEMBLY, COMPLETE For individual items, please refer to Dash Assembly BD.14166	D.18	1	FITTED TO R.H. DRIVE CARS at Chassis No. 824905 and subs.
BD.14069	DASH ASSEMBLY, COMPLETE		1	FITTED TO L.H. DRIVE CARS from Chassis No. 834001 to 834418
BD.16189	Mounting Plate Assembly, for Door Swing Arms		4	NO LONGER SUPPLIED. USE DASH ASSEMBLY BD.14165 FOR SERVICE PURPOSES.
UFS.125/SR	Screw, Set, securing Mounting Plates		32	
C.724	Washer, Shakeproof, on Setscrews		32	
UFN.125/L	Nut, on Setscrews		24	
BD.4555	Shim, for bottom Mounting Plates		As req'd	
BD.11009	Footrest and Dipswitch Bracket Assembly		1	
BD.14165	DASH ASSEMBLY, COMPLETE For individual items, please refer to Dash Assembly BD.14069		1	FITTED TO L.H. DRIVE CARS from Chassis No. 834419 to 835718
BD.14261	DASH ASSEMBLY, COMPLETE For individual items, please refer to Dash Assembly BD.14069		1	FITTED TO L.H. DRIVE CARS from Chassis No. 835719 to 836232 NO LONGER SUPPLIED. USE DASH ASSEMBLY BD.16846 FOR SERVICE PURPOSES.
BD.16846	DASH ASSEMBLY, COMPLETE For individual items, please refer to Dash Assembly BD.14069		1	FITTED TO L.H. DRIVE CARS at Chassis No. 836233 and subs.

BODY PANELS

FOR FIXED HEAD COUPE ONLY

FITTED WITH STANDARD OR OVERDRIVE TRANSMISSION

Part No.	Description	Plate No.	No. per Unit	Remarks
BD.12773	ATTACHMENT BRACKET ASSEMBLY, UNDER L.H. FRONT WING, FOR WING SUPPORT BRACKET	D.19	1	
BD.12774	ATTACHMENT BRACKET ASSEMBLY, UNDER R.H. FRONT WING, FOR WING SUPPORT BRACKET		1	
UFS.125/4R	Screw, Set, securing Attachment Brackets to Front Wings through Headlamp Containers		12	
FW.104/T	Washer, Plain, on Setscrews		12	
UFN.125/L	Nut, on Setscrews		12	
C.724	Washer, Shakeproof, under Nuts		12	
BD.12758	SUPPORT BRACKET ASSEMBLY, UNDER L.H. FRONT WING	D.20	1	
BD.12759	SUPPORT BRACKET ASSEMBLY, UNDER R.H. FRONT WING		1	
UFS.131/6R	Screw, Set, securing Support Brackets to Attachment Brackets		4	
BD.2070	Washer (Fibre) on Setscrews		As req'd	
C.725	Washer, Shakeproof, on Setscrews		4	
FW.105/T	Washer, Plain, under Shakeproof Washers		4	
UFB.131/8R	Screw, Set, securing Support Brackets to Chassis Frame		4	
FW.105/T	Washer, Plain, on Setscrews		4	
C.725	Washer, Shakeproof, on Setscrews		4	
BD.13110	FORWARD LOWER WING VALANCE ASSEMBLY	D.21	1	
BD.13108	VALANCE ASSEMBLY AT FORWARD END OF L.H. FRONT WING		1	
BD.13109	VALANCE ASSEMBLY AT FORWARD END OF R.H. FRONT WING	D.22	1	

BODY PANELS
FOR FIXED HEAD COUPE ONLY
FITTED WITH STANDARD OR OVERDRIVE TRANSMISSION

Part No.	Description	Plate No.	No. per Unit	Remarks
BD.12838	BRACKET ASSEMBLY FOR MOUNTING OF BONNET CATCH	D.23	1	
UFS.131/6R	Screw, Set, securing Bracket to Front Wing Support Brackets		10	
FW.105/T	Washer, Plain, on Setscrews		16	
C.8374	Washer, Special, on Setscrews at rear top fixing		4	
UFN.131/L	Nut, on Setscrews		10	
C.725	Washer, Shakeproof, under Nuts		10	
BD.15588/1	PLASTIC PLUG, SEALING BODY DRAIN HOLES		24	

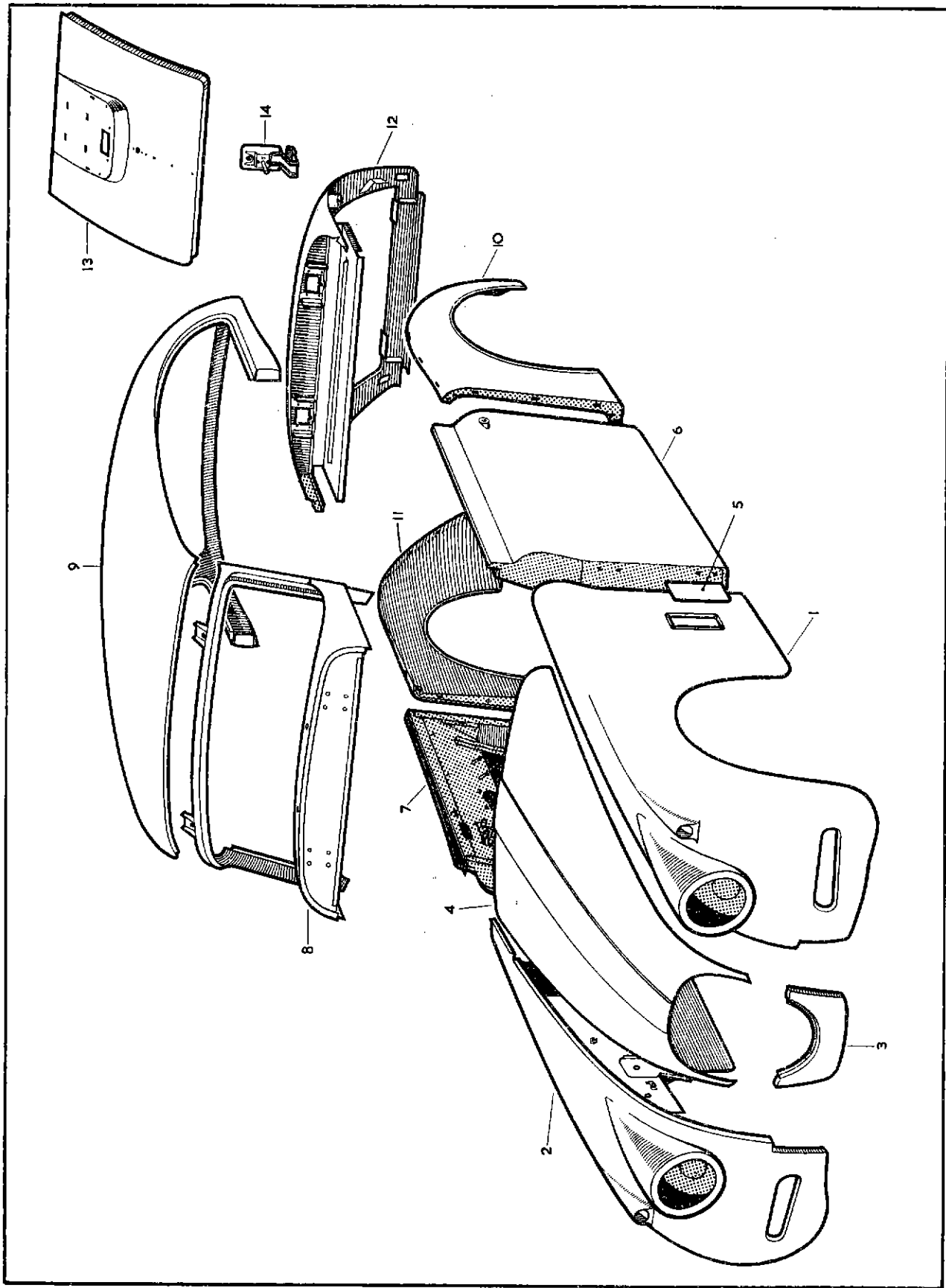

PLATE C

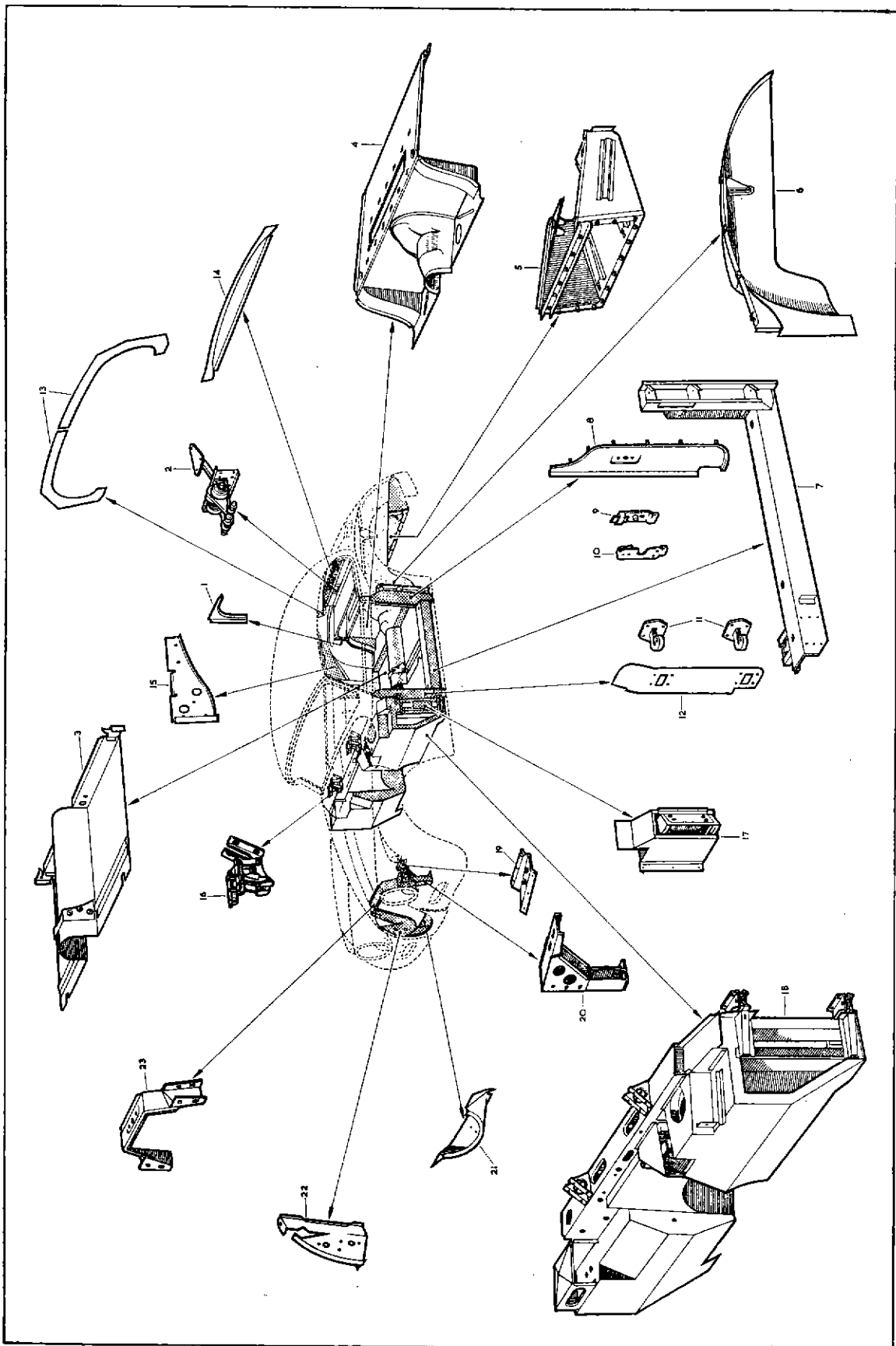

PLATE D

**AUTOMATIC TRANSMISSION
BODY PANELS
FOR FIXED HEAD COUPE ONLY**

Part No.	Description	Plate No.	No. per Unit	Remarks
BD.14168	DASH ASSEMBLY, COMPLETE		1	FITTED TO R.H. DRIVE CARS from Chassis No. 824001 to 824584
BD.16189 UFS.125/5R C.724 UFN.125/L BD.4555	Mounting Plate Assembly , for Door Swing Arms Screw , Set, securing Mounting Plates Washer , Shakeproof, on Setscrews Nut , on Setscrews Shim , for bottom Mounting Plates		4 32 32 24 As req'd	
BD.14264	DASH ASSEMBLY, COMPLETE For individual items, please refer to Dash Assembly BD.14168		1	FITTED TO R.H. DRIVE CARS from Chassis No. 824585 to 824904 NO LONGER SUPPLIED. USE DASH ASSEMBLY BD.16849 FOR SERVICE PURPOSES.
BD.16849	DASH ASSEMBLY, COMPLETE For individual items, please refer to Dash Assembly BD.14168		1	FITTED TO R.H. DRIVE CARS at Chassis No. 824905 and subs.
BD.14071	DASH ASSEMBLY, COMPLETE		1	FITTED TO L.H. DRIVE CARS from Chassis No. 834001 to 834406
BD.16189 UFS.125/5R C.724 UFN.125/L BD.4555 BD.11009	Mounting Plate Assembly , for Door Swing Arms Screw , Set, securing Mounting Plates Washer , Shakeproof, on Setscrews Nut , on Setscrews Shim , for bottom Mounting Plates Footrest and Dipswitch Bracket Assembly		4 32 32 24 As req'd 1	NO LONGER SUPPLIED. USE DASH ASSEMBLY BD.14167 FOR SERVICE PURPOSES.
BD.14167	DASH ASSEMBLY, COMPLETE For individual items, please refer to Dash Assembly BD.14071		1	FITTED TO L.H. DRIVE CARS from Chassis No. 834407 to 835718
BD.14263	DASH ASSEMBLY, COMPLETE For individual items, please refer to Dash Assembly BD.14071		1	FITTED TO L.H. DRIVE CARS from Chassis No. 835719 to 836232 NO LONGER SUPPLIED. USE DASH ASSEMBLY BD.16848 FOR SERVICE PURPOSES.
BD.16848	DASH ASSEMBLY, COMPLETE For individual items, please refer to Dash Assembly BD.14071		1	FITTED TO L.H. DRIVE CARS at Chassis No. 836233 and subs.

AUTOMATIC TRANSMISSION
BODY PANELS
FOR FIXED HEAD COUPE ONLY

Part No.	Description	Plate No.	No. per Unit	Remarks
BD.14488	REAR END ASSEMBLY		1	Fitted from Chassis No. 824001 to 824584 834001 to 835718
BD.12502	Tonneau Panel Assembly		1	
BD.14096	Sill Assembly, L.H.		1	
BD.14097	Sill Assembly, R.H.		1	
BD.19843	Rear Seat Panel Assembly (PG.2072)		1	
BD.12653	Wheel Arch Assembly, L.H.		1	
BD.12654	Wheel Arch Assembly, R.H.		1	
BD.12504	Face Panel Assembly, for L.H. Shut Pillar		1	
BD.12505	Face Panel Assembly, for R.H. Shut Pillar		1	
BD.13057	Sealing Plate Assembly, for L.H. Shut Pillar		1	
BD.13058	Sealing Plate Assembly, for R.H. Shut Pillar		1	
BD.11775	Fixed Floor Assembly		1	
BD.9326	Tray Assembly, holding Spare Wheel		1	
BD.14907	Boot Lid Shell Assembly		1	

BD.15802	REAR END ASSEMBLY		1	Fitted to Chassis No. 824585 and subs. 835719 and subs.
BD.15803	Tonneau Panel Assembly		1	
BD.15782	Wheel Arch Assembly, L.H.		1	

For all other items, please refer to Rear End Assembly BD.14488

BD.11775	FIXED FLOOR ASSEMBLY		1	
BD.6244	Tapped Plate, for attachment of Seat Slides		4	
UFS.525/5H	Screw, Set, securing Tapped Plates to underside of Floor		8	
BD.9409	Asbestos Sheet, under Fixed Floor		2	
BD.9410	Plate, supporting Asbestos Sheets		2	
BD.524/7	Bifurcated Rivet, securing Asbestos Sheets and Plates to Floor		22	

**FOR ITEMS NOT LISTED IN THIS SECTION,
PLEASE REFER TO SECTION FOR STANDARD OR OVERDRIVE TRANSMISSION CARS**

XK.150 'S' MODELS
BODY PANELS
FOR FIXED HEAD COUPE ONLY

Part No.	Description	Plate No.	No. per Unit	Remarks
BD.14975	FRONT WING AND VALANCE ASSEMBLY L.H.		1	
BD.15311	Valance Assembly only, L.H.		1	
BD.14978	FRONT WING AND VALANCE ASSEMBLY R.H.		1	
BD.14329	Valance Assembly only, R.H.		1	
BD.14567	DIAPHRAGM ASSEMBLY, BETWEEN R.H. FRONT WING AND DASH SIDE		1	
BD.15037/15	Seal (Sponge Rubber $\frac{1}{4}$"\times1$\frac{3}{8}$"\times35") on Diaphragm		1	
BD.15121	DIAPHRAGM ASSEMBLY, BETWEEN L.H. FRONT WING AND DASH SIDE		1	
BD.15037/15	Seal (Sponge Rubber $\frac{1}{4}$"\times1$\frac{3}{8}$"\times35") on Diaphragm		1	
BD.8291/2	Screw, Set, securing Diaphragms to Dash		14	
C.724	Washer, Shakeproof, on Setscrews		14	
BD.542/3	Washer, Special, under Shakeproof Washers		14	

**FOR ITEMS NOT LISTED IN THIS SECTION,
PLEASE REFER TO SECTION FOR STAND-
ARD OR OVERDRIVE TRANSMISSION
CARS**