

# BODY PANELS

FOR OPEN CARS ONLY

FITTED WITH STANDARD OR OVERDRIVE TRANSMISSION

Part No.	Description	Plate No.	No. per Unit	Remarks
BD.14972	<b>FRONT WING AND VALANCE ASSEMBLY, L.H.</b>		1	} <b>L.H. DRIVE CARS ONLY</b> Fitted from Chassis No. 830001 to 831139
BD.14974	<b>FRONT WING AND VALANCE ASSEMBLY, R.H.</b>		1	
BD.12631	Valance Assembly only, L.H.		1	
BD.14169	Valance Assembly only, R.H.		1	
BD.14975	<b>FRONT WING AND VALANCE ASSEMBLY, L.H.</b>	A.1	1	} Fitted to Chassis No. 820001 and subs. 831140 and subs.
BD.14976	<b>FRONT WING AND VALANCE ASSEMBLY, R.H.</b>	A.2	1	
BD.15311	Valance Assembly only, L.H.		1	
BD.14169	Valance Assembly only, R.H.		1	
BD.3553	<b>BRACKET FOR ATTACHMENT OF FRONT WING STEADY</b>		2	
UFS.125/5R FW.104/T UFN.125/L C.724	Screw, Set, securing Brackets at Battery Boxes Washer, Plain, on Setscrews Nut, on Setscrews Washer, Shakeproof, under Nuts		4 8 4 4	
BD.13383	<b>DIAPHRAGM ASSEMBLY BETWEEN L.H. FRONT WING AND DASH SIDE</b>		1	} <b>L.H. DRIVE CARS ONLY</b> Fitted from Chassis No. 830001 to 831139
BD.15037/11	Rubber Seal ( $\frac{1}{2}'' \times 1\frac{3}{8}'' \times 39''$ ) on Diaphragm		1	
BD.13384	<b>DIAPHRAGM ASSEMBLY BETWEEN R.H. FRONT WING AND DASH SIDE</b>		1	} <b>L.H. DRIVE CARS ONLY</b> Fitted from Chassis No. 830001 to 831523
BD.15037/11	Rubber Seal ( $\frac{1}{2}'' \times 1\frac{3}{8}'' \times 39''$ ) on Diaphragm		1	

# BODY PANELS

FOR OPEN CARS ONLY

FITTED WITH STANDARD OR OVERDRIVE TRANSMISSION

Part No.	Description	Plate No.	No. per Unit	Remarks
BD.15121	<b>DIAPHRAGM ASSEMBLY BETWEEN L.H. FRONT WING AND DASH SIDE</b>		1	} Fitted to Chassis No. 820001 and subs. 831140 and subs.
BD.15037/11	Rubber Seal ( $\frac{1}{4}'' \times 1\frac{3}{8}'' \times 39''$ ) on Diaphragm		1	
BD.14227	<b>DIAPHRAGM ASSEMBLY BETWEEN R.H. FRONT WING AND DASH SIDE</b>		1	} Fitted to Chassis No. 820001 and subs. 831524 and subs.
BD.15037/11	Rubber Seal ( $\frac{1}{4}'' \times 1\frac{3}{8}'' \times 39''$ ) on Diaphragm		1	
BD.8291	Screw, Set, securing Diaphragms to Dash		14	
BD.542/3	Washer, Special, on Setscrews		14	
C.724	Washer, Shakeproof, on Setscrews		14	
BD.12687	<b>FAIRING PANEL, BETWEEN FORWARD LOWER EDGES OF FRONT WINGS</b>	A.3	1	
BD.13411	<b>L.H. PLINTH PANEL ASSEMBLY BEHIND FRONT BUMPER</b>		1	} <b>REQUIRED FOR CARS FITTED WITH FOG LAMPS.</b>
BD.13412	<b>R.H. PLINTH PANEL ASSEMBLY BEHIND FRONT BUMPER</b>		1	
BD.14838	<b>L.H. PLINTH PANEL ASSEMBLY BEHIND FRONT BUMPER</b>		1	} <b>REQUIRED WHEN FOG LAMPS ARE NOT FITTED.</b>
BD.14839	<b>R.H. PLINTH PANEL ASSEMBLY BEHIND FRONT BUMPER</b>		1	
BD.8598	Piping, between Plinth Panel and Front Wings ( $19\frac{1}{2}''$ long)		2	
UFS.125/5R	Screw, Set, securing Plinth Panels to Front Wings		6	
FW.104/T	Washer, Plain, on Setscrews		6	
C.8667/1	Nut, Self Locking, on Setscrews		6	
BD.9292	Bracket, for fixing of Plinth Panels to Front Bumper		4	
UFN.125/L	Nut, securing Brackets to Bumper		4	
C.724	Washer, Shakeproof, under Nuts		4	
FW.104/T	Washer, Plain, under Shakeproof Washers		4	
BD.9301	Bolt, Shouldered, securing Brackets to Plinth Panels		4	
BD.541/13	Washer, Special, on Shouldered Bolts		4	
BD.4984	Washer, Rubber, between Brackets on Bumper and Brackets on Plinth Panel		4	
UFN.119/L	Nut, on Shouldered Bolts		4	
BD.4983	Washer, Special, under Nuts		4	

# BODY PANELS

FOR OPEN CARS ONLY

FITTED WITH STANDARD OR OVERDRIVE TRANSMISSION

Part No.	Description	Plate No.	No. per Unit	Remarks
BD.14439	<b>BONNET ASSEMBLY</b>		1	<b>L.H. DRIVE CARS ONLY</b> Fitted from Chassis No. 830001 to 831139
BD.15313	<b>BONNET ASSEMBLY</b>	A.4	1	Fitted to Chassis No. 820001 and subs. 831140 and subs.
BD.5188	<b>VENTILATOR DOOR ASSEMBLY IN FRONT WINGS</b>		2	} <b>L.H. DRIVE CARS ONLY</b> Fitted from Chassis No. 830001 to 831139
UFN.119/L C.723/A AW.102/T	<b>Nut</b> , securing Doors to Hinge Plates <b>Washer</b> , Shakeproof, under Nuts <b>Washer</b> , Plain, under Shakeproof Washers		6 6 6	
BD.5190	<b>SEAL FOR WING VENTILATOR DOORS</b>		2	
BD.5189	<b>GAUZE ASSEMBLY FOR WING VENTILATOR DOORS</b>		2	
BD.711/6	<b>Screw</b> , Self Tapping, securing Gauze to Doors		4	
BD.14724	<b>OUTER DOOR ASSEMBLY ON VENTILATOR BOXES IN FRONT WINGS</b>	A.5	2	
UFN.125/L C.724 FW.104/T	<b>Nut</b> , securing Outer Doors to Ventilator Boxes <b>Washer</b> , Shakeproof, under Nuts <b>Washer</b> , Plain, between Doors and Ventilator Boxes		8 8 16	} Fitted to Chassis No. 820001 and subs. 831140 and subs.
BD.14667	<b>GAUZE ASSEMBLY FOR OUTER DOORS</b>		2	
BD.540/9	<b>Screw</b> , Self Tapping, securing Gauze Assemblies		8	
BD.16091	<b>RUBBER SEAL FOR VENTILATOR DOORS</b>		2	

# BODY PANELS

FOR OPEN CARS ONLY

FITTED WITH STANDARD OR OVERDRIVE TRANSMISSION

Part No.	Description	Plate No.	No. per Unit	Remarks
BD.13784	<b>WINDSCREEN APERTURE PANEL ASSEMBLY</b>	A.6	1	
BD.15581	<b>DOOR SHELL ASSEMBLY, L.H.</b>	A.7	1	
BD.15582	<b>DOOR SHELL ASSEMBLY, R.H.</b>	A.8	1	
BD.15583	Hinge Face Panel Assembly, for L.H. Door		1	
BD.15584	Hinge Face Panel Assembly, for R.H. Door		1	
BD.15566	Guide Spring, for Check Arm		2	
BD.15569/1	Rivet, securing Springs		4	
BD.16106	Retainer, on L.H. Hinge Pillar, for Seal		1	
BD.16107	Retainer, on R.H. Hinge Pillar, for Seal		1	
BD.1814/2	Pop Rivet, securing Retainers		16	
BD.13137	Sealing Plate, lower, for Shut Pillars		2	
BD.14008	Insert (Hardwood) under Sealing Plates		2	
BD.539/12	Screw, Self Tapping, securing Sealing Plates		4	
BD.13996	Shut Pillar Assembly, for L.H. Door		1	
BD.13997	Shut Pillar Assembly, for R.H. Door		1	
BD.14583	Stiffener Assembly, in L.H. Door		1	
BD.14584	Stiffener Assembly, in R.H. Door		1	
UFS.125/4R	Screw, Set, securing Stiffeners		4	
FW.104/T	Washer, Plain, on Setscrews		4	
C.724	Washer, Shakeproof, on Setscrews		4	
BD.12734	Felt, behind Stiffener Rails (4" x 37")		2	
BD.13992	Outer Panel, for L.H. Door		1	
BD.13993	Outer Panel, for R.H. Door		1	
BD.12524	Bottom Panel, for L.H. Door		1	
BD.12525	Bottom Panel, for R.H. Door		1	
BD.14585	Garnish Rail Assembly, in L.H. Door		1	
BD.14586	Garnish Rail Assembly, in R.H. Door		1	
BD.14894	Reinforcing Plate Assembly, complete with Screwed Rod, for mounting of Armrests		2	
BD.16837	Steady Bracket Assembly, for Garnish Rail in L.H. Door		1	
BD.16838	Steady Bracket Assembly, for Garnish Rail in R.H. Door		1	
UFS.425/5H	Screw, Set, securing Steady Brackets to Garnish Rails		4	
UFS.125/4R	Screw, Set, securing Steady Brackets to Bottom Rails		2	
FW.104/T	Washer, Plain, on Setscrews		6	
C.724	Washer, Shakeproof, on Setscrews		6	
UFN.125/L	Nut, on Setscrews		2	
UFS.125/8R	Screw, Set, securing Doors to Hinge Swing Arms		16	
C.724	Washer, Shakeproof, on Setscrews		16	
BD.16155/1	Shim, between Doors and Swing Arms (20 s.w.g.)		As req'd	
BD.16155/2	Shim, between Doors and Swing Arms (16 s.w.g.)		As req'd	
BD.14923	<b>CHECK ARM ASSEMBLY, LIMITING OPENING ANGLE OF DOORS (WB.7/5040/2)</b>		2	
BD.14933	Pin, securing Check Arms to Brackets on Hinge Face Panels		2	
BD.847	Washer, Brass, on Pins		4	
L.102/4U	Split Pin, retaining Pins		2	

# BODY PANELS

FOR OPEN CARS ONLY

FITTED WITH STANDARD OR OVERDRIVE TRANSMISSION

Part No.	Description	Plate No.	No. per Unit	Remarks
BD.12530	<b>L.H. REAR WING ASSEMBLY</b>		1	} <b>REQUIRED WHEN DISC TYPE WHEELS ARE FITTED.</b>
BD.12531	<b>R.H. REAR WING ASSEMBLY</b>		1	
BD.4451	Striker Plate, on Rear Wings		2	
BD.4442	Swivel Rod, on Rear Wings		4	
BD.11178	Sealing Rubber, around Wheel Aperture on Rear Wings (54" long)		2	
BD.13379	<b>L.H. REAR WING ASSEMBLY</b>	A.9	1	} <b>REQUIRED WHEN WIRE SPOKE WHEELS ARE FITTED.</b>
BD.13380	<b>R.H. REAR WING ASSEMBLY</b>	A.10	1	
BD.7769	Moulding, around Wheel Aperture in L.H. Rear Wing		1	
BD.7770	Moulding, around Wheel Aperture in R.H. Rear Wing		1	
BD.1814/1	Pop Rivet, securing Mouldings		32	
BD.4449	<b>COVER ASSEMBLY FOR L.H. REAR WING</b>		1	} <b>FOR USE WHEN DISC TYPE ROAD WHEELS ARE FITTED.</b>
BD.4450	<b>COVER ASSEMBLY FOR R.H. REAR WING</b>		1	
BD.2121	Lock, on L.H. Cover (WB.12288/A)		1	
BD.2122	Lock, on R.H. Cover (WB.12288/B)		1	
UFS.519/4H	Screw, Set, securing Locks to Covers		4	
UFN.119/L	Nut, on Setscrews		4	
C.723/A	Washer, Shakeproof, under Nuts		4	
2312	<b>ESCUTCHEON FOR REAR WING COVERS</b>		2	} <b>FOR USE WHEN DISC TYPE ROAD WHEELS ARE FITTED.</b>
BD.540/9	Screw, Self Tapping, securing Escutcheons		4	

# BODY PANELS

## FOR OPEN CARS ONLY

FITTED WITH STANDARD OR OVERDRIVE TRANSMISSION

Part No.	Description	Plate No.	No. per Unit	Remarks
BD.8598	<b>PIPING BETWEEN REAR WINGS AND BODY (72" LONG)</b>		2	
BD.539/18	Screw, Self Tapping, securing Rear Wings and Piping to Body		18	
BD.541/13	Washer, on Self Tapping Screws		14	
UFN.125/L	Nut, securing Rear Wings to Body at front		12	
BD.542/3	Washer, Special, under Nuts		12	
C.724	Washer, Shakeproof, under Nuts		10	
BD.13565/2	Screw, Set, securing Rear Wings to Body ( $\frac{3}{8}$ " long)		4	
BD.13565/4	Screw, Set, securing Rear Wings to Body (1" long)		14	
BD.542/2	Washer, Special, on Setscrews		14	
C.725	Washer, Shakeproof, on Setscrews			
BD.6194	<b>STEADY ASSEMBLY FOR L.H. REAR WING</b>		1	
BD.6195	<b>STEADY ASSEMBLY FOR R.H. REAR WING</b>		1	
UFN.131/L	Nut, securing Steadies to Chassis and Wings		6	
C.725	Washer, Shakeproof, under Nuts		6	
BD.14569	<b>REAR END ASSEMBLY</b>		1	<b>L.H. DRIVE CARS ONLY</b> Fitted from Chassis No. 830001 to 831139
BD.14570	Tonneau Panel Assembly		1	
BD.14096	Sill Assembly, L.H.		1	
BD.14097	Sill Assembly, R.H.		1	
BD.19843	Rear Seat Panel Assembly (PG.2072)		1	
BD.15364	Wheel Arch Assembly, L.H.		1	
BD.15365	Wheel Arch Assembly, R.H.		1	
BD.13057	Sealing Plate Assembly, for L.H. Shut Pillar		1	
BD.13058	Sealing Plate Assembly, for R.H. Shut Pillar		1	
BD.14558	Face Panel Assembly, for L.H. Shut Pillar		1	
BD.14559	Face Panel Assembly, for R.H. Shut Pillar		1	
BD.9300	Fixed Floor Assembly		1	
BD.14907	Boot Lid Shell Assembly		1	
BD.9326	Tray Assembly, holding Spare Wheel		1	
BD.15807	<b>REAR END ASSEMBLY</b>		1	Fitted to Chassis No. 820001 and subs. 831140 and subs.
BD.15809	Tonneau Panel Assembly		1	
BD.15779	Wheel Arch Assembly, L.H.		1	
	For all other items please refer to Rear End			
	BD.14569			

# BODY PANELS

FOR OPEN CARS ONLY

FITTED WITH STANDARD OR OVERDRIVE TRANSMISSION

Part No.	Description	Plate No.	No. per Unit	Remarks
BD.14570	<b>TONNEAU PANEL ASSEMBLY</b>		1	<b>L.H. DRIVE CARS ONLY</b> Fitted from Chassis No. 830001 to 831139
BD.14681	Top Panel Assembly, for Tonneau		1	
BD.14001	L.H. Panel, for Tonneau		1	
BD.14002	R.H. Panel, for Tonneau		1	
BD.12668	Panel Assembly, lower, for Tonneau		1	
BD.12886	Bottom Panel, for Tonneau		1	
BD.12651	Gutter Assembly, for Luggage Compartment Lid Aperture		1	
BD.12503	Cross Member Assembly, for Tonneau		1	
BD.16725	Tray Assembly, reinforcing Tonneau		1	
BD.15809	<b>TONNEAU PANEL ASSEMBLY</b>	A.11	1	Fitted to Chassis No. 820001 and subs. 831140 and subs.
BD.15798	L.H. Panel, for Tonneau		1	
BD.16035	R.H. Panel, for Tonneau		1	
BD.16963	Cross Member Assembly, for Tonneau		1	
For all other items please refer to Tonneau Panel Assembly BD.14570				
BD.14907	<b>BOOT LID SHELL ASSEMBLY</b>	A.12	1	
BD.16797	Mounting Bracket Assembly, for L.H. Hinge		1	
BD.16798	Mounting Bracket Assembly, for R.H. Hinge		1	
M.108/6R	Woodscrew, securing Mounting Brackets to Frame		16	
BD.17389	Reinforcement Angle, on second Rail		1	
M.108/6R	Woodscrew, securing Angle		6	
UFS.125/4R	Screw, Set, securing Hinges to Boot Lid		2	
UFS.125/5R	Screw, Set, securing Hinges to Boot Lid		4	
FW.104/T	Washer, Plain, on Setscrews		4	
BD.541/9	Washer, Special, on Setscrews		6	
C.724	Washer, Shakeproof, on Setscrews		6	
BD.16784	Packing, at Hinge Mounting		6	As req'd
BD.9397	<b>PETROL FILLER BOX ASSEMBLY</b>		1	<b>L.H. DRIVE CARS ONLY</b> Fitted from Chassis No. 830001 to 830559
BD.9489	Snapsac Sleeve, on Filler Box, for Lock Striker		1	
BD.4368	Hose, connecting Filler Box to Petrol Tank		1	
C.2905/7	Clip, securing Hose to Filler Box and Tank		2	
BD.4369	Extension Tube (Rubber) for Drain Pipe on Filler Box		1	
C.5574	Grommet, in Wheel Arch Panel, for Extension Tube		1	
BD.15613	<b>PETROL FILLER BOX ASSEMBLY</b>		1	<b>L.H. DRIVE CARS ONLY</b> Fitted from Chassis No. 830560 to 831139
BD.9489	Snapsac Sleeve, on Filler Box, for Lock Striker		1	
BD.4368	Hose, connecting Filler Box to Petrol Tank		1	
C.2905/7	Clip, securing Hose to Filler Box and Tank		2	
BD.4369	Extension Tube (Rubber) for Drain Pipe on Filler Box		1	
C.5574	Grommet, in Wheel Arch Panel, for Extension Tube		1	

# BODY PANELS

FOR OPEN CARS ONLY

FITTED WITH STANDARD OR OVERDRIVE TRANSMISSION

Part No.	Description	Plate No.	No. per Unit	Remarks
BD.4358	<b>HINGE ASSEMBLY FOR PETROL FILLER DOOR</b>		1	<b>L.H. DRIVE CARS ONLY</b> Fitted from Chassis No. 830001 to 831139
UFS.319/3H C.723/A	Screw, Set, securing Hinge inside Petrol Filler Box Washer, Shakeproof, on Setscrews		2 2	
BD.4357	<b>DOOR ASSEMBLY FOR PETROL FILLER BOX</b>		1	<b>L.H. DRIVE CARS ONLY</b> Fitted from Chassis No. 830001 to 831139
UFN.119/L C.723/A AW.102/T BD.4354	Nut, securing Door to Hinges Washer, Shakeproof, under Nuts Washer, Plain, under Nuts Rubber Seal, around Filler Box Aperture, seating Door		4 4 4 1	
BD.4360	<b>LOCK ASSEMBLY FOR PETROL FILLER DOOR</b>		1	
BD.8071	Spring Clip, securing Lock to Door (WB.7/4098)		1	
BD.4353	<b>STRIKER ASSEMBLY FOR PETROL FILLER LOCK</b>		1	
BD.10641 UFN.119/L C.723/A AW.102/T	Stud Plate, for fixing of Striker inside Petrol Filler Box Nut, securing Stud Plate and Striker Washer, Shakeproof, under Nuts Washer, Plain, under Shakeproof Washers		1 2 2 2	
BD.3699	<b>FILLER CAP ON HINGE</b>		1	<b>L.H. DRIVE CARS ONLY</b> Fitted from Chassis No. 830001 to 831139
BD.3189 BD.4394 L.102/4U C.2501/3	Cork Seal, inside Filler Cap Spring, between Filler Cap and Hinge Split Pin, securing Filler Cap to Hinge Washer, Plain, under Split Pin		1 1 1 1	
BD.15735	<b>PETROL FILLER BOX ASSEMBLY</b>		1	
BD.4368 C.2905/7 BD.4369 C.5574	Hose, connecting Filler Box to Tank Clip, securing Hose to Filler and Tank Extension Tube (Rubber) for Drain Pipe on Filler Box Grommet, in Wheel Arch Panel for Extension Tube		1 2 1 1	



# BODY PANELS

FOR OPEN CARS ONLY

FITTED WITH STANDARD OR OVERDRIVE TRANSMISSION

Part No.	Description	Plate No.	No. per Unit	Remarks
BD.15743	<b>DOOR ASSEMBLY FOR PETROL FILLER BOX</b>	A.13	1	Fitted to Chassis No. 820001 and subs. 831140 and subs.
BD.4366	Spring, for Hinge		1	
BD.4394	Spring, on Petrol Cap		1	
BD.8082	Plate, retaining Spring (253/278)		1	
L.102/4U	Split Pin, securing Plate		1	
C.2501/3	Washer, Plain, under Split Pin		1	
BD.8076	Rubber Cap, on spring-retaining Plate		1	
BD.9278	Rubber Insert, for Cup		1	
BD.16257/2	Screw, Set, securing Door Assembly to Filler Box		2	
C.723/A	Washer, Shakeproof, on Setscrews		2	
BD.9184	<b>CATCH BRACKET ASSEMBLY IN PETROL FILLER BOX (WB.7/9183)</b>		1	Fitted to Chassis No. 820001 and subs. 831140 and subs.
BD.16257/2	Screw, Set, securing Catch Bracket to Filler Box		.2	
C.723/A	Washer, Shakeproof, on Setscrews		2	
AW.102/T	Washer, Plain, under Shakeproof Washers		2	
BD.16256	<b>LOCK, IN PETROL FILLER DOOR (WB.7/23023)</b>		1	Fitted to Chassis No. 820001 and subs. 831140 and subs.
BD.8071	Spring Clip, securing Lock		1	
BD.4321	Rubber Buffer, in Petrol Filler Aperture, cushioning Door when closed		2	
BD.12800	<b>COVER PLATE, OVER PETROL FILLER PIPE</b>		1	<b>L.H. DRIVE CARS ONLY</b> Fitted from Chassis No. 830001 to 831139
BD.539/17	Screw, Self Tapping, securing Cover Plate		4	
BD.9584	Rubber Seal, under Cover Plate		1	
BD.15811	<b>COVER PLATE, OVER PETROL FILLER PIPE</b>		1	Fitted to Chassis No. 820001 and subs. 831140 and subs.
BD.539/17	Screw, Self Tapping, securing Cover Plate		4	
BD.9584	Rubber Seal, under Cover Plate		1	

# BODY PANELS

FOR OPEN CARS ONLY

FITTED WITH STANDARD OR OVERDRIVE TRANSMISSION

Part No.	Description	Plate No.	No. per Unit	Remarks
BD.12503	<b>CROSS MEMBER ASSEMBLY FOR TONNEAU</b>		1	Fitted from Chassis No. 820001 to 820018 830001 to 831909
BD.13360	Bracket Assembly, for Boot Lid L.H. Hinge		1	
BD.13361	Bracket Assembly, for Boot Lid R.H. Hinge		1	
BD.12831	Arm Assembly, for Boot Lid Hinges		2	
BD.13363	Pin, hinging Boot Lid		2	
C.724	Washer, Shakeproof, on Hinge Pins		2	
UFN.225/L	Nut, on Hinge Pins		4	
UFS.125/4R	Screw, Set, securing Hinge Brackets to Cross Member		16	
C.724	Washer, Shakeproof, on Setscrews		16	
FW.104/T	Washer, Plain, on Setscrews		12	
BD.4332	Bridge Piece, at Upper fixing		2	
BD.16963	<b>CROSS MEMBER ASSEMBLY FOR TONNEAU</b>	B.1	1	Fitted to Chassis No. 820019 and subs. 831910 and subs.
BD.16579	Tapped Plate, on Cross Member, for fixing of Boot Lid Hinges		4	
BD.17733	<b>L.H. HINGE ASSEMBLY FOR BOOT LID</b>	B.2	1	Fitted from Chassis No. 820019 to 820037 831910 to 832073
BD.17734	<b>R.H. HINGE ASSEMBLY FOR BOOT LID</b>	B.3	1	
BD.16085	Spring, for Boot Lid Hinges (WB.7/9464)		4	
BD.15711	Pin, anchoring Boot Lid Hinge Springs		2	
BD.15712	Roller, on Pins		2	
L.104/12U	Split Pin, retaining Springs on Support Brackets		4	
BD.15714	Washer, under Split Pins		4	
L.104/7U	Split Pin, retaining Springs on Anchor Pins		4	
BD.15717	Washer, under Split Pins		4	
BD.16690	Tapped Plate, for fixing of Boot Lid Hinges (4½" long)		2	
BD.16691	Tapped Plate, for fixing of Boot Lid Hinges (4" long)		2	
UFS.125/4R	Screw, Set, securing Hinge Assemblies to Cross Member		16	
C.724	Washer, Shakeproof, on Setscrews		16	
BD.16245	<b>L.H. HINGE ASSEMBLY FOR BOOT LID</b>	B.2	1	Fitted to Chassis No. 820038 and subs. 832074 and subs.
BD.16246	<b>R.H. HINGE ASSEMBLY FOR BOOT LID</b>	B.3	1	
	For replaceable items, please refer to Hinge Assemblies BD.17733/4			

# BODY PANELS

FOR OPEN CARS ONLY

FITTED WITH STANDARD OR OVERDRIVE TRANSMISSION

Part No.	Description	Plate No.	No. per Unit	Remarks
BD.16713	<b>RUBBER BUFFER, CUSHIONING HINGE ARMS WHEN BOOT LID IS OPEN</b>		2	Fitted to Chassis No. 820038 and subs. 832074 and subs.
BD.16717	Fixing Plate, for securing of Rubber Buffers		2	
BD.14399	Screw, Set, through Fixing Plates, securing Rubber Buffers to Cross Member		2	
C.723/A	Washer, Shakeproof, on Setscrews		2	
BD.541/28	Washer, Plain, under Shakeproof Washers		2	
BD.19843	<b>REAR SEAT PANEL ASSEMBLY (PG.2072)</b>	B.4	1	
BD.13932	Panel Assembly, forward Boot Floor		1	
BD.9006	Asbestos Pad, on Panel, for Heat Insulation from Exhaust System		1	
BD.9010	Asbestos Pad, on Panel, for Heat Insulation from Exhaust System		1	
BD.9021	Retaining Plate, for Asbestos Insulation		1	
BD.9022	Retaining Plate, for Asbestos Insulation		1	
BD.524/6	Bifurcated Rivet, securing Plates and Asbestos to Panels		14	
BD.9023	Cover Plate, over Aperture in L.H. Panel		1	
BD.538/5	Screw, Self Tapping, securing Cover Plate		6	
BD.9005	Asbestos Disc, under Cover Plate		1	
BD.9020	Retaining Plate, for Asbestos Disc		1	
BD.524/6	Bifurcated Rivet, securing Asbestos Disc and Retaining Plate to Cover Plate		3	
BD.16725	<b>TRAY ASSEMBLY, REINFORCING TONNEAU</b>	B.5	1	
BD.14887	Support Plate Assembly, at L.H. side of Tonneau	B.6	1	
BD.14888	Support Plate Assembly, at R.H. side of Tonneau		1	
BD.15365	<b>R.H. WHEEL ARCH ASSEMBLY</b>		1	
BD.12656	R.H. Wheel Arch Panel only		1	
BD.12664	Butt Strap, for Wheel Arch		1	
BD.8681	Clip, for Electrical Wiring		5	
BD.9312	Support Assembly at rear of R.H. Wheel Arch		1	
BD.14710	Mounting Plate Assembly, for Hood Sticks Pivot		1	
BD.14705	Pivot Bracket Assembly, for Hoodsticks		1	
BD.8291/2	Screw, Set, securing Pivot Bracket		2	
C.724	Washer, Shakeproof, on Setscrews		2	
FWV.104/T	Washer, Plain, under Shakeproof Washers		2	
C.5647	Rubber Plug, in Wheel Arch Panel		2	

# BODY PANELS

FOR OPEN CARS ONLY

FITTED WITH STANDARD OR OVERDRIVE TRANSMISSION

Part No.	Description	Plate No.	No. per Unit	Remarks
BD.15364	<b>L.H. WHEEL ARCH ASSEMBLY</b>		1	<b>L.H. DRIVE CARS ONLY</b> Fitted from Chassis No. 830001 to 831139
BD.12655	L.H. Wheel Arch Panel only		1	
BD.8681	Clip, for Electrical Wiring		4	
BD.9311	Support Assembly at rear of L.H. Wheel Arch		1	
BD.14709	Mounting Plate Assembly, for Hoodsticks Pivot		1	
	For all other items, please refer to R.H. Wheel Arch, BD.15365			
BD.15779	<b>L.H. WHEEL ARCH ASSEMBLY</b>	B.7	1	Fitted to Chassis No. 820001 and subs. 831140 and subs.
BD.15780	L.H. Wheel Arch Panel only		1	
BD.8681	Clip, for Electrical Wiring		4	
BD.9311	Support Assembly at rear of L.H. Wheel Arch		1	
BD.14709	Mounting Plate Assembly, for Hoodsticks Pivot		1	
	For all other items, please refer to R.H. Wheel Arch BD.15365			
BD.14458	<b>FACE PANEL ASSEMBLY FOR L.H. SHUT PILLAR</b>	B.8	1	
BD.14459	<b>FACE PANEL ASSEMBLY FOR R.H. SHUT PILLAR</b>		1	
BD.16129	Tapped Plate, for retention of Door Lock Strikers		2	
BD.16126	Retainer, on L.H. Face Panel, for Tapped Plate		1	
BD.16127	Retainer, on R.H. Face Panel, for Tapped Plate		1	
BD.13800	<b>STRIKER ASSEMBLY FOR L.H. DOOR LOCK (WB.3/4801/1)</b>	B.9	1	
BD.13801	<b>STRIKER ASSEMBLY FOR R.H. DOOR LOCK (WB.3/4802/1)</b>		1	
BD.10930	Packing, under Strikers (18 S.W.G.)		As req'd	
BD.14670/2	Screw, Set, securing Strikers		4	

# BODY PANELS

FOR OPEN CARS ONLY

FITTED WITH STANDARD OR OVERDRIVE TRANSMISSION

Part No.	Description	Plate No.	No. per Unit	Remarks
BD.13802	<b>STRIKING PLATE FOR L.H. DOOR LOCK (WB.3—9290/0)</b>	B.10	1	
BD.13803	<b>STRIKING PLATE FOR R.H. DOOR LOCK (WB.3—9291/0)</b>		1	
BD.14096	<b>L.H. DOOR SILL ASSEMBLY</b>	B.11	1	
BD.14097	<b>R.H. DOOR SILL ASSEMBLY</b>		1	
BD.14073	Outer Panel, for L.H. Door Sill		1	
BD.14074	Outer Panel, for R.H. Door Sill		1	
BD.14098	Inner Panel Assembly, for L.H. Door Sill		1	
BD.14099	Inner Panel Assembly, for R.H. Door Sill		1	
BD.4107	Plate, reinforcing Sill Mountings		4	
BD.13901	Mounting Bracket Assembly, Sill to Dash, L.H.		1	
BD.13902	Mounting Bracket Assembly, Sill to Dash, R.H.		1	
BD.12726	Shut Pillar Assembly, L.H.		1	
BD.12727	Shut Pillar Assembly, R.H.		1	
BD.10158	Retainer, on side of Sills, for Door Seals		2	
BD.13056	Retainer, at top of Sills, for Draught Excluder		2	
BD.1814/2	Pop Rivet, securing Retainers		28	
UFS.137/8R	Screw, Set, securing Sills to Dash		12	
FW.106/T	Washer, Plain, on Setscrews		12	
C.726	Washer, Shakeproof, on Setscrews		12	
BD.10078	<b>SEALING PLATE ASSEMBLY, BETWEEN SILL AND L.H. FRONT WING</b>		1	
BD.10705	<b>SEALING PLATE ASSEMBLY, BETWEEN SILL AND R.H. FRONT WING</b>		1	
BD.711/18	Screw, Self Tapping, securing Sealing Plates		8	
BD.13057	<b>SEALING PLATE ASSEMBLY, FOR L.H. SHUT PILLAR</b>		1	
BD.15037/2	Seal (Sponge Rubber $\frac{1}{4}'' \times 1\frac{3}{8}'' \times 3\frac{1}{4}''$ ) on Sealing Plate		1	
BD.15037/10	Seal (Sponge Rubber $\frac{1}{4}'' \times 1\frac{3}{8}'' \times 28\frac{1}{4}''$ ) on Sealing Plate		1	

# BODY PANELS

FOR OPEN CARS ONLY

FITTED WITH STANDARD OR OVERDRIVE TRANSMISSION

Part No.	Description	Plate No.	No. per Unit	Remarks
BD.13058	<b>SEALING PLATE ASSEMBLY, FOR R.H. SHUT PILLAR</b>		1	
BD.15037/2	Seal (Sponge Rubber $\frac{1}{4} \times 1\frac{3}{8} \times 3\frac{1}{4}$ ") on Sealing Plate		1	
BD.15037/10	Seal (Sponge Rubber $\frac{1}{4} \times 1\frac{3}{8} \times 28\frac{1}{2}$ ") on Sealing Plate		1	
BD.8691/3	Screw, Self Tapping, securing Sealing Plates at side		8	
BD.711/9	Screw, Self Tapping, securing Sealing Plates at bottom		6	
AW.102/T	Washer, Plain, on Self-Tapping Screws		14	
BD.15570	<b>SWING ARM, MOUNTING DOORS TO BODY</b>	B.12	4	
UFB.131/11R	Bolt, through Mounting Plates, pivoting Swing Arms		4	
BD.13207	Bush (Steel) on Bolts		4	
C.8667/2	Nut, Self-locking, on Bolts		4	
FW.105/T	Washer, Plain, under Nuts		4	
BD.15573	<b>HINGE FACE PANEL, L.H.</b>	B.13	1	
BD.15574	<b>HINGE FACE PANEL, R.H.</b>		1	
BD.9300	<b>FIXED FLOOR ASSEMBLY</b>	B.14	1	
BD.6244	Tapped Plate, for attachment of Seat Slides		4	
UFS.525/5H	Screw, Set, securing Tapped Plates to underside of Floor		8	
BD.9409	Asbestos Sheet, under Fixed Floor		2	
BD.9410	Fixing Plate, holding Asbestos Sheets		2	
BD.524/7	Rivet, Bifurcated, securing Asbestos Sheets and Fixing Plates to Floor		22	
BD.9326	<b>TRAY ASSEMBLY, HOLDING SPARE WHEEL</b>	B.15	1	

# BODY PANELS

FOR OPEN CARS ONLY

FITTED WITH STANDARD OR OVERDRIVE TRANSMISSION

Part No.	Description	Plate No.	No. per Unit	Remarks
BD.5183	<b>VENTILATOR BOX ASSEMBLY IN L.H. FRONT WING</b>		1	} <b>L.H. DRIVE CARS ONLY</b> Fitted from Chassis No. 830001 to 831139
BD.5184	<b>VENTILATOR BOX ASSEMBLY IN R.H. FRONT WING</b>		1	
BD.5127	Hinge Assembly, on L.H. Ventilator Box		1	
BD.5128	Hinge Assembly, on R.H. Ventilator Box		1	
BD.648	Spring Plunger, on Hinges		2	
R.303/5W	Rivet, securing Plungers		2	
C.3350	Brass Washer, at each side of Plungers		4	
BD.650	Loose Head, for end of Rivets		2	
UFS.519/3H	Screw, Set, securing Hinge to Boxes		6	
UFN.119/L	Nut, on Setscrews		6	
AG.102/X	Washer, Spring, under Nuts		6	
BD.5176	Spring, for Ventilator Doors		2	
BD.5125	Sleeve, housing Springs		2	
L.104/10U	Split Pin, securing Sleeves		2	
C.3571	Slug, adjusting Spring Tension		As req'd	
BD.3712/1	Adjusting Plate, between Hinge and Ventilator Door (.064" thick)		As req'd	
BD.3712/2	Adjusting Plate, between Hinge and Ventilator Door (.048" thick)		As req'd	
BD.3712/3	Adjusting Plate, between Hinge and Ventilator Door (.036" thick)		As req'd	
BD.3712/4	Adjusting Plate, between Hinge and Ventilator Door (.022" thick)		As req'd	
BD.14646	<b>VENTILATOR BOX ASSEMBLY IN L.H. FRONT WING</b>	B.16	1	Fitted to Chassis No. 820001 and subs. 831140 and subs.
BD.14651	Mounting Plate Assembly, for Outer Door		1	
UFS.519/3H	Screw, Set, securing Mounting Plate to Ventilator Box		5	
UFN.119/L	Nut, on Setscrews		5	
C.723/A	Washer, Shakeproof, under Nuts		5	
BD.15431	Operating Lever, for Ventilator		1	
UFS.519/3H	Screw, Set, securing Operating Lever		2	
UFN.119/L	Nut, on Setscrews		2	
C.723/A	Washer, Shakeproof, under Nuts		2	
BD.4616	Rubber Buffer, cushioning Operating Lever		2	
BD.14726	Spring, between top of Mounting Plate and Ventilator Box		1	
BD.14792	Spring, between bottom of Mounting Plate and Ventilator Box		1	
BD.16339	Attachment Plate, for fixing of Ventilator Box to Body Interior		1	
BD.711/3	Screw, Self Tapping, securing attachment Plate to Box		4	
BD.711/2	Screw, Self Tapping, securing Ventilator Box to Body		7	
BD.711/1	Screw, Self Tapping, securing Ventilator Box to Wing		6	

# BODY PANELS

FOR OPEN CARS ONLY

FITTED WITH STANDARD OR OVERDRIVE TRANSMISSION

Part No.	Description	Plate No.	No. per Unit	Remarks
BD.14730	<b>VENTILATOR BOX ASSEMBLY IN R.H. FRONT WING</b>		1	Fitted to Chassis No. 820001 and subs. 831140 and subs.
BD.14735	<b>Mounting Plate Assembly, for Outer Door</b>		1	
UFS.519/3H	<b>Screw, Set, securing Mounting Plate to Ventilator Box</b>		5	
UFN.119/L	<b>Nut, on Setscrews</b>		5	
C.723/A	<b>Washer, Shakeproof, under Nuts</b>		5	
BD.15430	<b>Operating Lever, for Ventilator Door</b>		1	
UFS.519/3H	<b>Screw, Set, securing Operating Lever to Mounting Plate</b>		2	
UFN.119/L	<b>Nut, on Setscrews</b>		2	
C.723/A	<b>Washer, Shakeproof, under Nuts</b>		2	
BD.4616	<b>Rubber Buffer, cushioning Operating Lever</b>		2	
BD.14726	<b>Spring, between bottom of Mounting Plate and Ventilator Box</b>		1	
BD.14792	<b>Spring, between top of Mounting Plate and Ventilator Box</b>		1	
BD.711/1	<b>Screw, Self Tapping, securing Ventilator Box to Wing</b>		6	
BD.711/2	<b>Screw, Self Tapping, securing Ventilator Box to Body Interior</b>		7	
BD.14457	<b>DASH ASSEMBLY, COMPLETE</b>		1	<b>FITTED TO R.H. DRIVE CARS</b> from Chassis No. 820001 to 820042 <b>NO LONGER SUPPLIED. USE DASH ASSEMBLY BD.16851 FOR SERVICE PURPOSES.</b>
BD.16189	<b>Mounting Plate Assembly, for Door Swing Arms</b>		4	
UFS.125/5R	<b>Screw, Set, securing Mounting Plates</b>		32	
C.724	<b>Washer, Shakeproof, on Setscrews</b>		32	
UFN.125/L	<b>Nut, on Setscrews</b>		24	
BD.4555	<b>Shim, for bottom Mounting Plates</b>		As req'd	
BD.16851	<b>DASH ASSEMBLY, COMPLETE</b>	B.17	1	<b>FITTED TO R.H. DRIVE CARS</b> at Chassis No. 820043 and subs.
	<b>For individual items, please refer to Dash Assembly BD.14457</b>			
BD.14452	<b>DASH ASSEMBLY, COMPLETE</b>		1	<b>FITTED TO L.H. DRIVE CARS</b> from Chassis No. 830001 to 831139
BD.16189	<b>Mounting Plate Assembly, for Door Swing Arms</b>		4	
UFS.125/5R	<b>Screw, Set, securing Mounting Plates</b>		32	
C.724	<b>Washer, Shakeproof, on Setscrews</b>		32	
UFN.125/L	<b>Nut, on Setscrews</b>		24	
BD.4555	<b>Shim, for bottom Mounting Plates</b>		As req'd	
BD.11009	<b>Footrest and Dipswitch Bracket Assembly</b>		1	



# BODY PANELS

FOR OPEN CARS ONLY

FITTED WITH STANDARD OR OVERDRIVE TRANSMISSION

Part No.	Description	Plate No.	No. per Unit	Remarks
BD.14456	<b>DASH ASSEMBLY, COMPLETE</b>  For individual items, please refer to Dash Assembly BD.14452		1	<b>FITTED TO L.H. DRIVE CARS</b> from Chassis No. 831140 to 832087  <b>NO LONGER SUPPLIED. USE DASH ASSEMBLY BD.16850 FOR SERVICE PURPOSES.</b>
BD.16850	<b>DASH ASSEMBLY, COMPLETE</b>  For individual items, please refer to Dash Assembly BD.14452		1	<b>FITTED TO L.H. DRIVE CARS</b> at Chassis No. 832088 and subs.
BD.14446	<b>BONNET HINGE ASSEMBLY</b>		2	<b>L.H. DRIVE CARS ONLY</b> Fitted from Chassis No. 830001 to 831139
BD.16089	Hinge only for Bonnet		2	
BD.14274	Lower Bracket		2	
BD.15089	Mounting Bracket		2	
BD.15090	Tapped Plate, for mounting of Bracket		2	
UFS.125/4R	Screw, Set, securing Hinges to Bonnet and Dash		28	
C.724	Washer, Shakeproof, on Setscrews		28	
FW.104/T	Washer, Plain, on Setscrews		28	
BD.15340	<b>L.H. HINGE ASSEMBLY FOR BONNET</b> B.18		1	} Fitted to Chassis No. 820001 and subs. 831140 and subs.
BD.14446	<b>R.H. HINGE ASSEMBLY FOR BONNET</b> B.19		1	
BD.16090	L.H. Hinge only		1	
BD.16089	R.H. Hinge only		1	
BD.14274	Lower Bracket, for R.H. Hinge		1	
BD.15089	Mounting Bracket		2	
BD.15090	Tapped Plate, for fixing of Mounting Bracket		2	
UFS.125/4R	Screw, Set, securing Hinges to Bonnet and Dash		26	
FW.104/T	Washer, Plain, on Setscrews		26	
C.724	Washer, Shakeproof, on Setscrews		26	
UFN.125/L	Nut, on Setscrews		3	

# BODY PANELS

FOR OPEN CARS ONLY

FITTED WITH STANDARD OR OVERDRIVE TRANSMISSION

Part No.	Description	Plate No.	No. per Unit	Remarks
BD.12773	<b>ATTACHMENT BRACKET ASSEMBLY, UNDER L.H. FRONT WING, FOR WING SUPPORT BRACKET</b>	B.20	1	
BD.12774	<b>ATTACHMENT BRACKET ASSEMBLY, UNDER R.H. FRONT WING, FOR WING SUPPORT BRACKET</b>		1	
UFS.125/4R	Screw, Set, securing Attachment Brackets to Front Wings through Headlamp Containers		12	
FW.104/T	Washer, Plain, on Setscrews		12	
UFN.125/L	Nut, on Setscrews		12	
C.724	Washer, Shakeproof, under Nuts		12	
BD.12758	<b>SUPPORT BRACKET ASSEMBLY, UNDER L.H. FRONT WING</b>	B.21	1	
BD.12759	<b>SUPPORT BRACKET ASSEMBLY, UNDER R.H. FRONT WING</b>		1	
UFS.131/6R	Screw, Set, securing Support Brackets to Attachment Brackets		4	
C.725	Washer, Shakeproof, on Setscrews		4	
FW.105/T	Washer, Plain, under Shakeproof Washers		4	
BD.2070	Fibre Washer, on Setscrews		As req'd	
BD.13110	<b>FORWARD LOWER WING VALANCE ASSEMBLY</b>	B.22	1	
BD.13108	<b>VALANCE ASSEMBLY AT FORWARD END OF L.H. FRONT WING</b>		1	
BD.13109	<b>VALANCE ASSEMBLY AT FORWARD END OF R.H. FRONT WING</b>	B.23	1	

# BODY PANELS

## FOR OPEN CARS ONLY

FITTED WITH STANDARD OR OVERDRIVE TRANSMISSION

Part No.	Description	Plate No.	No. per Unit	Remarks
BD.12838	<b>BRACKET ASSEMBLY FOR MOUNTING OF BONNET CATCH</b>	B.24	1	
UFS.151/6R	<b>Screw, Set, securing Bonnet Catch Bracket to Front Wing Support Brackets</b>		10	
FW.105/T	<b>Washer, Plain, on Setscrews</b>		16	
C.8374	<b>Washer, Special, at rear top fixing</b>		4	
UFN.131/L	<b>Nut, on Setscrews</b>		10	
C.725	<b>Washer, Shakeproof, on Setscrews</b>		10	
BD.19588/1	<b>PLASTIC PLUG, SEALING BODY DRAIN HOLES</b>		24	

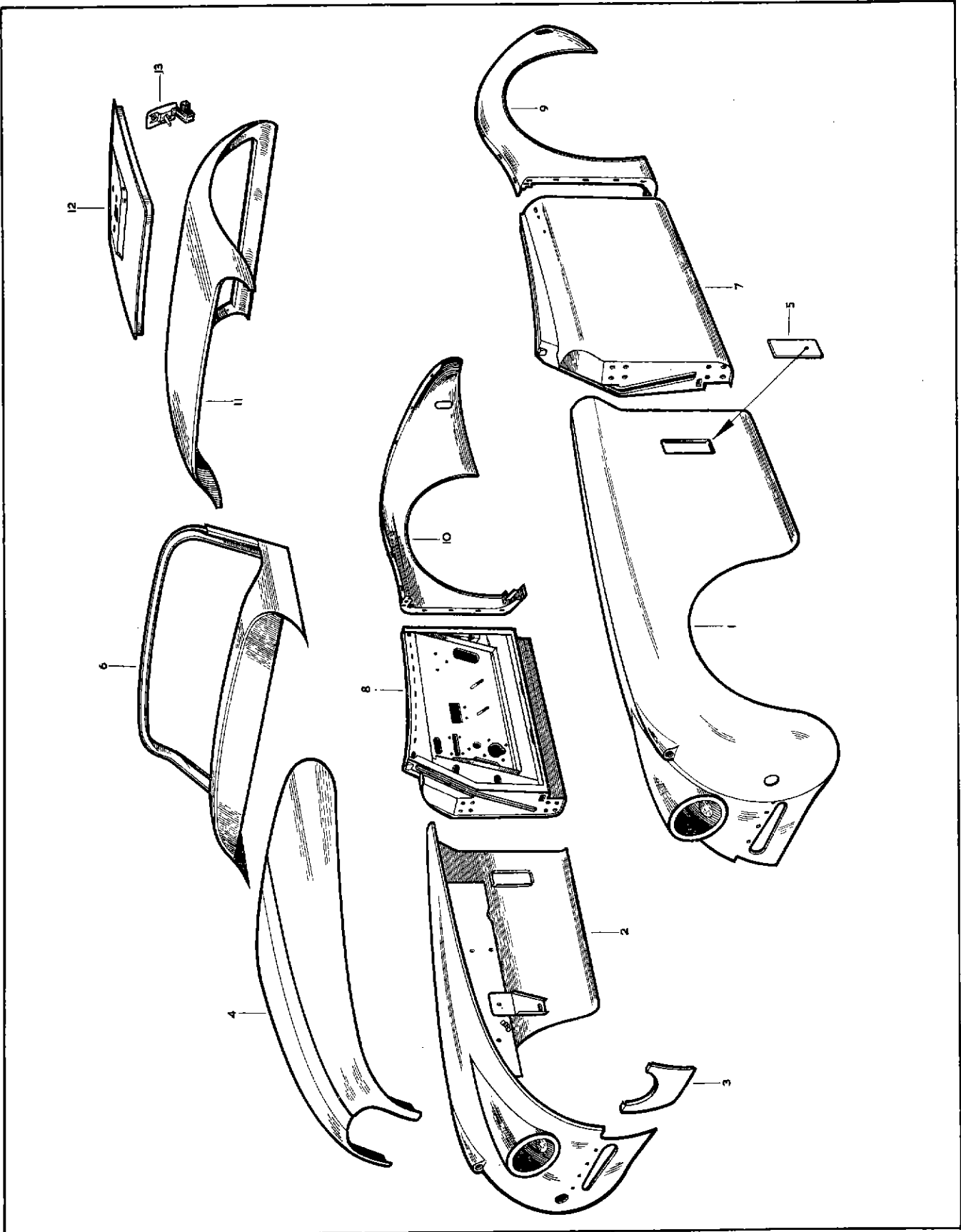

PLATE A

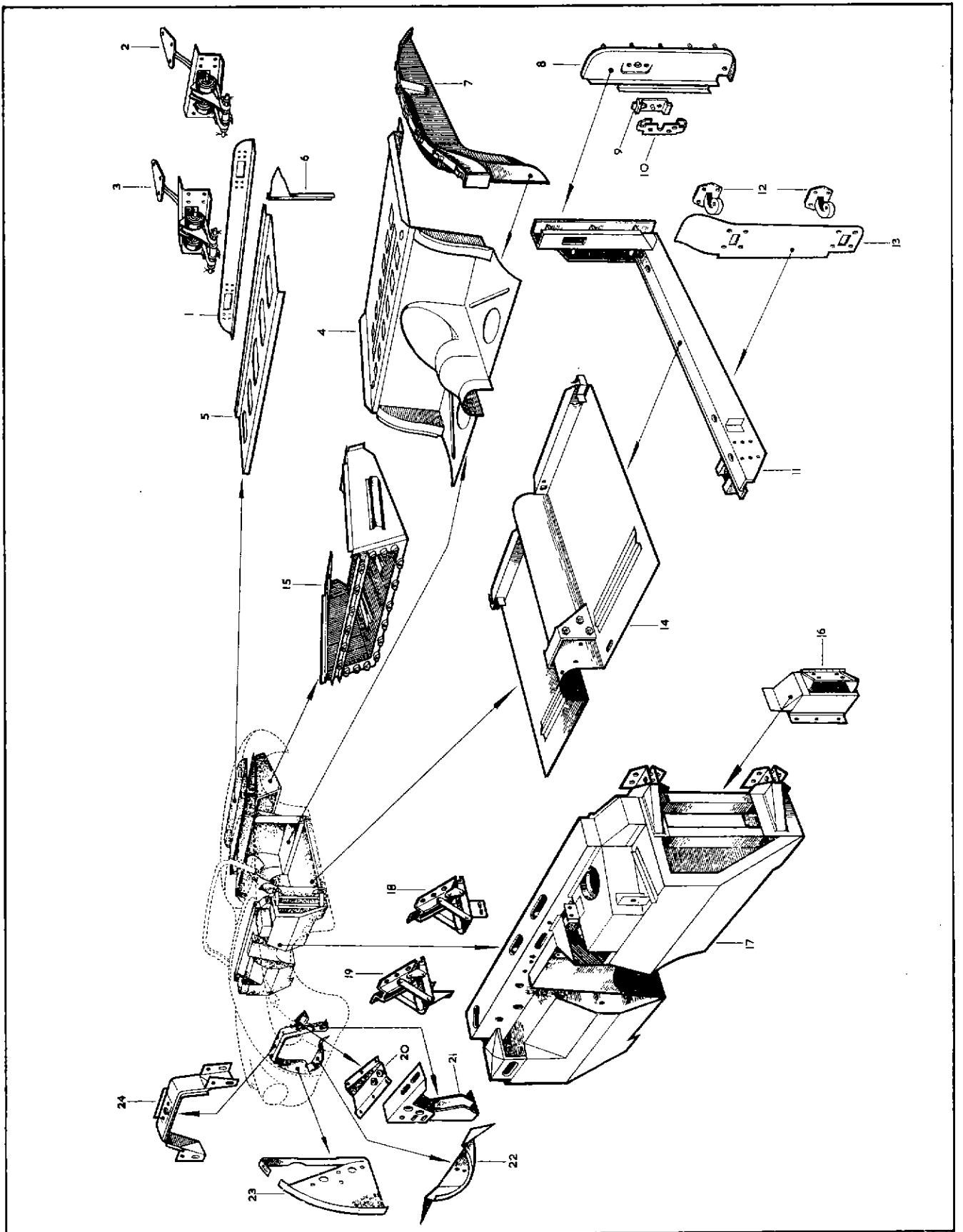

PLATE B

**AUTOMATIC TRANSMISSION  
BODY PANELS  
FOR OPEN CARS ONLY**

Part No.	Description	Plate No.	No. per Unit	Remarks
BD.14459	<b>DASH ASSEMBLY, COMPLETE</b>		1	<b>FITTED TO R.H. DRIVE CARS</b> from Chassis No. 820001 to 820042
BD.16189	<b>Mounting Plate Assembly, for Door Swing Arms</b>		4	<b>NO LONGER SUPPLIED. USE DASH ASSEMBLY BD.16853 FOR SERVICE PURPOSES.</b>
UFS.125/SR	<b>Screw, Set, securing Mounting Plates</b>		32	
C.724	<b>Washer, Shakeproof, on Setscrews</b>		32	
UFN.125/L	<b>Nut, on Setscrews</b>		24	
BD.4555	<b>Shim, for bottom Mounting Plates</b>		As req'd	
BD.16853	<b>DASH ASSEMBLY, COMPLETE</b>		1	<b>FITTED TO R.H. DRIVE CARS</b> at Chassis No. 820043 and subs.
	<b>For individual items, please refer to Dash Assembly BD.14459</b>			
BD.14454	<b>DASH ASSEMBLY, COMPLETE</b>		1	<b>FITTED TO L.H. DRIVE CARS</b> from Chassis No. 830001 to 831139
BD.16189	<b>Mounting Plate Assembly, for Door Swing Arms</b>		4	<b>NO LONGER SUPPLIED. USE DASH ASSEMBLY BD.16852 FOR SERVICE PURPOSES.</b>
UFS.125/SR	<b>Screw, Set, securing Mounting Plates</b>		32	
C.724	<b>Washer, Shakeproof, on Setscrews</b>		32	
UFN.125/L	<b>Nut, on Setscrews</b>		24	
BD.4555	<b>Shim, for bottom Mounting Plates</b>		As req'd	
BD.11009	<b>Footrest and Dipswitch Bracket Assembly</b>		1	
BD.14458	<b>DASH ASSEMBLY, COMPLETE</b>		1	<b>FITTED TO L.H. DRIVE CARS</b> from Chassis No. 831140 to 832087
	<b>For individual items, please refer to Dash Assembly BD.14454</b>			
BD.16852	<b>DASH ASSEMBLY, COMPLETE</b>		1	<b>FITTED TO L.H. DRIVE CARS</b> at Chassis No. 832088 and subs.
	<b>For individual items, please refer to Dash Assembly BD.14454</b>			

# AUTOMATIC TRANSMISSION

## BODY PANELS

FOR OPEN CARS ONLY

Part No.	Description	Plate No.	No. per Unit	Remarks
BD.16036	<b>REAR END ASSEMBLY</b>		1	<b>L.H. DRIVE CARS ONLY</b> Fitted from Chassis No. 830001 to 831139
BD.14570	Tonneau Panel Assembly		1	
BD.14096	Sill Assembly, L.H.		1	
BD.14097	Sill Assembly, R.H.		1	
BD.19843	Rear Seat Panel Assembly (PG.2072)		1	
BD.15364	Wheel Arch Assembly, L.H.		1	
BD.15365	Wheel Arch Assembly, R.H.		1	
BD.13057	Sealing Plate Assembly, for L.H. Shut Pillar		1	
BD.13058	Sealing Plate Assembly, for R.H. Shut Pillar		1	
BD.14558	Face Panel Assembly, for L.H. Shut Pillar		1	
BD.14559	Face Panel Assembly, for R.H. Shut Pillar		1	
BD.11775	Fixed Floor Assembly		1	
BD.14907	Boot Lid Shell Assembly		1	
BD.15808	<b>REAR END ASSEMBLY</b>		1	Fitted to Chassis No. 820001 and subs. 831140 and subs.
BD.15809	Tonneau Panel Assembly		1	
BD.15779	Wheel Arch Assembly, L.H.		1	
For all other items please refer to Rear End BD.16036				
BD.11775	<b>FIXED FLOOR ASSEMBLY</b>		1	
BD.6244	Tapped Plate, for attachment of Seat Slides		4	
UFS.525/5H	Screw, Set, securing Tapped Plates to underside of Floor		8	
BD.9409	Asbestos Sheet, under Fixed Floor		2	
BD.9410	Fixing Plate, supporting Asbestos Sheets		2	
BD.524/7	Bifurcated Rivet, securing Asbestos Sheets and Plates to Floor		22	
<b>FOR ITEMS NOT LISTED IN THIS SECTION, PLEASE REFER TO SECTION FOR STAND- ARD OR OVERDRIVE TRANSMISSION CARS</b>				

**XK.150 'S' MODELS**  
**BODY PANELS**  
**FOR OPEN CARS ONLY**

Part No.	Description	Plate No.	No. per Unit	Remarks
BD.14975	<b>FRONT WING AND VALANCE ASSEMBLY L.H.</b>		1	
BD.15311	Valance Assembly only, L.H.		1	
BD.14978	<b>FRONT WING AND VALANCE ASSEMBLY R.H.</b>		1	
BD.14329	Valance Assembly only, R.H.		1	
BD.15121	<b>DIAPHRAGM ASSEMBLY BETWEEN L.H. FRONT WING AND DASH SIDE</b>		1	
BD.15037/11	Seal (Sponge Rubber $\frac{1}{4}'' \times 1\frac{3}{8}'' \times 39''$ ) on Diaphragm		1	
BD.14567	<b>DIAPHRAGM ASSEMBLY BETWEEN R.H. FRONT WING AND DASH SIDE</b>		1	
BD.15037/15	Seal (Sponge Rubber $\frac{1}{4}'' \times 1\frac{3}{8}'' \times 35''$ ) on Diaphragm		1	
BD.8291/2	Screw, Set, securing Diaphragms to Dash		14	
C.724	Washer, Shakeproof, on Setscrews		14	
BD.542/3	Washer, Special, under Shakeproof Washers		14	

**FOR ITEMS NOT LISTED IN THIS SECTION,  
PLEASE REFER TO SECTION FOR STAND-  
DARD OR OVERDRIVE TRANSMISSION  
CARS**



# XK.150 'S' MODELS

## BODY FITTINGS

### FOR OPEN CARS ONLY

Part No.	Description	Plate No.	No. per Unit	Remarks
BD.15403	<b>STIFFENER ASSEMBLY, UNDER R.H. FRONT WING</b>		1	
UFS.125/4R	<b>Screw</b> , Set, securing Stiffener to Air Cleaner Housing		4	
BD.542/3	<b>Washer</b> , Special, on Setscrews		4	
C.724	<b>Washer</b> , Shakeproof, on Setscrews		4	
BD.15392	<b>HOUSING ASSEMBLY, UNDER R.H. FRONT WING, FOR AIR CLEANER</b>		1	
BD.15037/15	<b>Seal</b> (Sponge Rubber $\frac{1}{8}'' \times 1\frac{3}{8}'' \times 35''$ ) on Housing		1	
UFS.125/4R	<b>Screw</b> , Set, securing Housing		14	
BD.542/3	<b>Washer</b> , Special, on Setscrews		14	
C.724	<b>Washer</b> , Shakeproof, on Setscrews		14	
BD.12934	<b>BATTERY BOX ASSEMBLY IN L.H. FRONT WING</b>		1	} <b>REQUIRED FOR L.H. DRIVE CARS ONLY.</b>
BD.14360	<b>BATTERY BOX ASSEMBLY IN R.H. FRONT WING</b>		1	
BD.6596	<b>Spring</b> , on Battery Boxes, receiving "Dzus" Fasteners		8	
R.102/4W	<b>Rivet</b> , securing Springs		16	
BD.12936	<b>BATTERY BOX ASSEMBLY IN L.H. FRONT WING</b>		1	} <b>REQUIRED FOR R.H. DRIVE CARS ONLY.</b>
BD.14359	<b>BATTERY BOX ASSEMBLY IN R.H. FRONT WING</b>		1	
BD.6596	<b>Spring</b> , on Battery Boxes, receiving "Dzus" Fasteners		8	
R.102/4W	<b>Rivet</b> , securing Springs		16	
UFS.125/5R	<b>Screw</b> , Set, securing Battery Boxes		8	
BD.542/3	<b>Washer</b> , Special, on Setscrews		8	
UFN.125/L	<b>Nut</b> , on Setscrews		8	
C.724	<b>Washer</b> , Shakeproof, under Nuts		8	

**XK.150 'S' MODELS**  
**BODY FITTINGS**  
**FOR OPEN CARS ONLY**

Part No.	Description	Plate No.	No. per Unit	Remarks
BD.14941	<b>PROP ASSEMBLY SUPPORTING BONNET IN RAISED POSITION</b>		1	
BD.15699	<b>Pivot</b> , on L.H. Front Wing Valance, for Bonnet Prop		1	
UFN.125/L	<b>Nut</b> , securing Pivot		1	
C.724	<b>Washer</b> , Shakeproof, under Nut		1	
FW.104/T	<b>Washer</b> , Plain, under Shakeproof Washer		1	
L.102/6U	<b>Split Pin</b> , securing Prop to Pivot		1	
BD.1708/1	<b>Washer</b> , Double Coil Spring, on Pivot		1	
FW.105/T	<b>Washer</b> , Plain, on Pivot		1	
BD.14717	<b>BRACKET AT L.H. SIDE OF BONNET RECEIVING PROP</b>		1	
BD.13324	<b>Tapped Plate</b> , for fixing of Bracket		1	
UFS.125/4R	<b>Screw</b> , Set, securing Bracket		2	
C.724	<b>Washer</b> , Shakeproof, on Setscrews		2	
BD.14943	<b>BRACKET ASSEMBLY, RETAINING BONNET PROP WHEN NOT IN USE</b>		1	
UFS.419/4H	<b>Screw</b> , Set, securing Bracket to L.H. Front Wing Valance		2	
UFN.119/L	<b>Nut</b> , on Setscrews		2	
C.723/A	<b>Washer</b> , Shakeproof, under Nuts		2	
BD.16132	<b>"S" EMBLEM ON L.H. DOOR</b>		1	
BD.16133	<b>"S" EMBLEM ON R.H. DOOR</b>		1	
BD.10735	<b>Spire Nut</b> , securing Emblems		8	
BD.15293	<b>Rubber Washer</b> , under Spire Nut		8	
BD.15123	<b>L.H. FRONT FLOOR BOARD ASSEMBLY</b>		1	<b>L.H. DRIVE CARS ONLY.</b>
BD.9909/6	<b>Tee Nut</b> , for Accelerator Pedal fixing		3	

**XK.150 'S' MODELS**  
**BODY FITTINGS**  
**FOR OPEN CARS ONLY**

Part No.	Description	Plate No.	No. per Unit	Remarks
BD.15360	<b>GEARBOX COVER ASSEMBLY</b>		1	<b>REQUIRED ONLY WHEN OVER-DRIVE UNIT IS ELECTRICALLY CONTROLLED.</b>
BD.9623	Cover, exposing Overdrive Solenoid		1	
BD.14400/2	Screw, Set, securing Cover		4	
C.723/A	Washer, Shakeproof, on Setscrews		4	
BD.1288/3	Spring Clip, for attachment of Dipstick Cover		2	
BD.1289/2	Rivet, securing Spring Clips		4	
BD.15361	Gauntlet Panel, surrounding Change Speed Lever		1	
BD.14399/1	Screw, Set, securing Gauntlet Panel to Gearbox Cover		9	
FW.104/T	Washer, Plain, on rear Setscrew		1	
C.738	Washer, Shakeproof, on Setscrew		9	
BD.16044	<b>GEARBOX COVER ASSEMBLY</b>		1	<b>REQUIRED ONLY WHEN OVER-DRIVE UNIT IS MANUALLY CONTROLLED.</b>
	<b>For individual items, please refer to Gearbox Cover BD.15360</b>			
BD.10524/1	Seal (Sponge Rubber) between Gearbox Cover and Propeller Shaft Tunnel		1	
BD.13819/2	Screw, Set, securing Gearbox Cover to Clutch Housing		6	
FW.104/T	Washer, Plain, on Setscrews		6	
C.724	Washer, Shakeproof, on Setscrews		6	
BD.8691/4	Screw, Self Tapping, securing Gearbox Cover to Floorboards		8	
BD.542/3	Washer, Special, on Self Tapping Screws		8	
BD.13819/1	Screw, Set, securing Gearbox Cover to Propeller Shaft Tunnel		3	
C.724	Washer, Shakeproof, on Setscrews		3	
BD.8279	<b>INSPECTION COVER ASSEMBLY EXPOSING GEARBOX DIPSTICK</b>		1	
BD.1288/1	Stud, for fixing of Inspection Cover		2	
BD.1288/2	Washer, securing Studs		2	
	<b>CARPETS AND FELTS FOR USE WHEN OVERDRIVE UNIT IS ELECTRICALLY CONTROLLED</b>			
BD.18901	Carpet Assembly, for Gearbox Cover (1763)		1	Fitted from Chassis No. 820001 to 820068 830336 to 832117
BD.18597	Carpet Assembly, for Gearbox Cover (1201)		1	Fitted to Chassis No. 820069 and subs. 832118 and subs.
BD.13894	Flintkote, at top of Gearbox Cover (21"×27")		1	
BD.13895	Flintkote, at centre of Gearbox Cover (9½"×10½")		1	
BD.13906	Rubberised Felt, at top of Gearbox Cover (22"×27")		1	
BD.13907	Rubberised Felt, at centre of Gearbox Cover (9"×11")		1	

**XK.150 'S' MODELS**  
**BODY FITTINGS**  
**FOR OPEN CARS ONLY**

Part No.	Description	Plate No.	No. per Unit	Remarks
<b>CARPETS AND FELTS FOR USE WHEN OVERDRIVE UNIT IS MANUALLY CONTROLLED</b>				
BD.16048	<b>Carpet Assembly</b> , for Gearbox Cover (1763)		1	Fitted from Chassis No. 820001 to 820068 830336 to 832117
BD.18639	<b>Carpet Assembly</b> , for Gearbox Cover (1201)		1	Fitted to Chassis No. 820069 and subs. 832118 and subs.
BD.16047	<b>Grommet</b> , in Gearbox Cover Carpet		1	
BD.16053	<b>Flintkote</b> , at top of Gearbox Cover (21"×27")		1	
BD.13895	<b>Flintkote</b> , at centre of Gearbox Cover (9½"×10½")		1	
BD.16052	<b>Rubberised Felt</b> , at top of Gearbox Cover (22"×27")		1	
BD.13907	<b>Rubberised Felt</b> , at centre of Gearbox Cover (9"×11")		1	
BD.15304	<b>SWITCH BASE ASSEMBLY ON FACIA BOARD</b>		1	<b>REQUIRED ONLY WHEN OVER- DRIVE UNIT IS ELECTRICALLY CONTROLLED.</b>
BD.15305	<b>Base only</b>		1	
M.108/16R	<b>Woodscrew</b> , securing Switch Base to Facia		2	
 <b>FOR ITEMS NOT LISTED IN THIS SECTION, PLEASE REFER TO SECTION FOR STAN- DARD TRANSMISSION CARS</b>				