

CHASSIS

Part No.	Description.	Plate No.	No. per Unit.	Remarks.
C.3387	CHASSIS FRAME, COMPLETE	T.1	1	Fitted from Chassis No. 660001 to 660058 670001 to 670184
C.3387/1	CHASSIS FRAME, COMPLETE		1	Fitted to Chassis No. 660059 to 660993 669001 to 669002 670185 to 672481 679001 to 671985
C.6692	CHASSIS FRAME, COMPLETE		1	Fitted to Chassis No. 660994 and subs. 672482 and subs.
C.6762	CHASSIS FRAME, COMPLETE		1	Fitted to Chassis No. 669003 and subs. 679816 and subs. 667001 and subs. 677001 and subs.
C.3825	Crossmember, Centre, Assy.	T.2	1	
C.3394	Crossmember, Front	T.3	1	
C.3430	Crossmember, Rear	T.4	1	
C.3416	Plate, Shackle, on Rear Crossmember	T.5	2	
C.3886	Bracket for R.H. Steering Lock Stop	T.6	1	
C.3887	Bracket for L.H. Steering Lock Stop	T.7	1	
NS.131/12D	Bolt, Stop, for Steering Lock		2	
N.N.131/L	Nut on Stop Bolts		4	
C.3431	Bracket, Mounting, for Radiator	T.8	2	
C.3432	Bracket, Holding down, for Radiator	T.9	2	
C.3433	Bracket, Stay, for Radiator	T.10	2	
C.5838	Channel for Bonnet Lock Mounting Plate		1	
C.6791	Bracket for mounting of Radiator		2	Fitted to Chassis No. 669001 and subs. 679001 and subs. 667001 and subs. 677001 and subs.
C.3883	Bracket Assembly for Front Suspension, R.H.	T.11	1	
C.3884	Bracket Assembly for Front Suspension, L.H.	T.12	1	
C.3396	Bracket, Engine Mounting, Front R.H.	T.13	1	
C.3397	Bracket, Engine Mounting, Front L.H.		1	
C.3248	Housing for Clutch Shaft Bearing		2	
C.3399	Bracket, Stop, R.H., for Clutch Pedal	T.14	2	
NB.125/10D	Bolt, for Clutch Pedal Stop		2	
N.N.125/L	Nut on Bolts		2	
C3627	Bracket, L.H., mounting Brake Cylinder	T.15	1	Fitted from Chassis No. 660001 to 660979 669001 to 669002 670001 to 672048 679001 to 679621
C3624	Bracket, R.H., mounting Brake Cylinder	T.16	1	
C.6694	Bracket, R.H., mounting Brake Cylinder		1	Fitted to Chassis No. 660980 and subs. 669003 and subs. 672049 and subs. 679622 and subs. 667001 and subs. 677001 and subs.
C.6695	Bracket, L.H., mounting Brake Cylinder		1	
C.3188	Bracket, R.H., mounting Brake Pedal		1	
C.3199	Bracket, L.H., mounting Brake Pedal		1	
C.3407	Bracket, Reaction, for R.H. Torsion Bar	T.17	1	
C.3408	Bracket, Reaction, for L.H. Torsion Bar	T.18	1	
C.3406	Bracket, mounting Engine at Rear	T.19	1	
NB.137/6D	Bolt, securing Engine Mounting to Bracket		3	
NN.137/L	Nut on Bolts		3	
C.3402	Bracket for Handbrake attachment	T.20	1	
C.3403	Tube in Handbrake Attachment Bracket		2	
C.3413	Bracket, Outer Front, for R.H. Rear Spring		1	
C.3414	Bracket, Outer Front, for L.H. Rear Spring		1	
C.3415	Bracket, Inner Front, for Rear Spring		2	
C.3419	Extension Assembly, R.H.	T.21	1	
C.3420	Extension Assembly, L.H.	T.22	1	
C.3207	Bracket, Support, for Rear Rebound Buffer	T.23	2	
C.3428	Bracket for Rebound Strap	T.24	4	
C.3640	Bracket for Front and Rear Brake Hoses	T.25	3	
C.3855	Bracket for Brake Pipe Junction	T.26	2	
C.5790	Bracket Assembly, R.H., for Front Bumper	T.27	1	
C.5791	Bracket Assembly, L.H., for Front Bumper	T.28	1	
C.5779	Bracket Assembly, No. 1, R.H., for Mounting Body	T.29	1	
C.5780	Bracket Assembly No. 1, L.H., for Mounting Body		1	
C.5781	Bracket Assembly No. 2, R.H., for Mounting Body		1	
C.5782	Bracket Assembly No. 2, L.H., for Mounting Body	T.30	1	
C.3598	Socket for Jack	T.31	2	
1048/A	Plug for Jack Socket	T.32	2	
C.3055	Bracket for Anti-Roll Bar	T.33	2	
C.3434	Bracket for Propellor Shaft Tunnel	T.34	2	
C.3646	Bracket Assembly fixing Silencer at front end		1	
C.3649	Bracket, mounting Petrol Pump	T.35	1	
C.3758	Bracket, Scuttle Stiffener	T.36	2	
C.3846	Bracket for Wing Supports		2	
C.3489	Bracket, mounting Damper	T.37	1	
C.3866	Bracket for Front Wing Valance	T.38	2	

CHASSIS

Part No.	Description.	Plate No.	No. per Unit.	Remarks.
C.3661	REAR ROAD SPRING	T.39	2	Fitted from Chassis No. 660001 to 661039 669001 to 669002 670001 to 673319 679001 to 680396
C.5721	REAR ROAD SPRING		2	Fitted to Chassis No. 661040 and subs. 669003 and subs. 673320 and subs. 680397 and subs. 667001 and subs. 677001 and subs.
C.1639	Washer (Ferobestos) for Road Springs		8	
869	Washer (Steel) for Road Springs		8	
C.611	Washer (Fibre) for Road Springs		4	
C.1219	Bush (Metalastik) in each eye of Spring	T.40	4	
NB.143/28F	Pin, securing Springs at front and rear ends	T.41	4	
C.3670	Piece, Distance, between front eye of Springs and Chassis Frame	T.42	2	
C.3320/4	Nut, Self-Locking, on Spring Pins	T.43	4	
FW.107/T	Washer on Spring Pins	T.44	4	
C.640	Shackle, anchoring rear end of Spring	T.45	2	
C.1219	Bush (Metalastik) in Shackle	T.46	2	
NB.143/23F	Pin, securing Shackle to Frame	T.47	2	
C.3651	Washer, Tab, locking Shackle Pins	T.48	2	
C.3829	Piece, Packing, for Spring Seat	T.49	2	REQUIRED ONLY WHEN REAR AXLE C.3452, C.3821, C.4460, C.4461 or C.4462 IS FITTED
C.3843	Peg, locating Packing Piece	T.50	2	
C.3671	Bolt "U" securing Rear Axle to Spring	T.51	4	REQUIRED ONLY WHEN E.N.V. REAR AXLE IS FITTED
C.3095	Plate, under Springs, for "U" Bolts	T.52	2	
C.6676	Bolt "U" securing Rear Axle to Springs		4	REQUIRED ONLY WHEN SALIS-BURY REAR AXLE IS FITTED
C.3094	Plate, under Springs, for "U" Bolts		2	
NN.150/L	Nut, securing "U" Bolts	T.53	8	
NN.250/L	Nut, Lock, on "U" Bolts	T.54	8	
C.3877	Gaiter, Spring, Front	T.55	2	
C.3878	Gaiter, Spring, Rear	T.56	2	
C.3429	REAR AXLE REBOUND STRAP	T.57	2	
632	Buffer (Rubber) at bottom of Rebound Straps	T.58	2	
NB.137/7D	Bolt, securing Rebound Straps		4	
C.3116/3	Nut on Bolts		4	
FG.106/X	Washer, Spring, under Nuts		4	
SHOCK ABSORBERS				
C.3035	Absorber, Shock, Front (Newton)	T.59	2	Fitted from Chassis No. 660001 to 660979 669001 to 669002 670001 to 672048 679001 to 679621
C.7183	Absorber, Shock, Front (Newton)		2	Fitted to Chassis No. 660980 and subs. 669003 and subs. 672049 and subs. 679622 and subs. 667001 and subs. 677001 and subs.
C.3053	Buffer (Rubber) at top of Shock Absorber	T.60	4	
C.3273	Bush, Conical (Rubber) in eye of Shock Absorber	T.61	4	
C.3753	Absorber, Shock, L.H. Rear (Girling)	T.62	1	Fitted from Chassis No. 660001 to 660985 669001 to 669002 670001 to 672279 679001 to 679728
C.3752	Absorber, Shock, R.H. Rear (Girling)	T.63	1	
C.7214	Absorber, Shock, Rear R.H.		1	Fitted to Chassis No. 660986 and subs. 669003 and subs. 672280 and subs. 679729 and subs. 667001 and subs. 677001 and subs.
C.7215	Absorber, Shock, Rear L.H.		1	
677	Link-and-Pin Assy., for Rear Shock Absorbers (SA.250/17)		2	
1893	Bush for Link-and-Pin Assy. (9007/16)		4	
L.104/10U	Pin, Split, securing Newton Shock Absorber to Lower Rear Wishbone Pin		2	
FW.110/T	Washer at each side of Shock Absorber eye		4	
NB.156/30D	Bolt, securing Girling Shock Absorbers to Frame		4	
FW.109/T	Washer, Plain, on Bolts		4	
NN.156/L	Nut on Bolts		4	
C.729	Washer, Shakeproof, under Nuts		4	

CHASSIS

Part No.	Description.	Plate No.	No. per Unit.	Remarks.
C.3036	REBOUND BUFFER, FRONT	T.64	2	
C.3208	REBOUND BUFFER, REAR	T.65	2	
NB.125/5D	Bolt , securing Front Buffer to underside of Front Suspension Bracket		4	
NN.125/L	Nut on Bolts		4	
FG.104/X	Washer, Spring, under Nuts		4	
NB.131/5D	Bolt , securing Rear Rebound Buffer to Bracket on Frame Extension		4	
NN.131/L	Nut on Bolts		4	
FG.105/X	Washer, Spring, under Nuts		4	
EXHAUST SYSTEM				
C.3523	Pipe, Exhaust (Twin) from Manifolds to Silencer	T.66	1	
C.3523/2	Pipe (Flexible) for Twin Exhaust Pipe		1	
C.495	Gasket between Exhaust Pipe and Manifold Flanges	T.67	2	
C.3285	Clip, securing Twin Exhaust Pipe to Silencer	T.68	1	
NB.131/23D	Bolt through Clip	T.69	1	
FW.105/T	Washer on Bolt	T.70	2	
NN.131/L	Nut on Bolt	T.71	1	
C.3524	Silencer	T.72	1	Fitted to Chassis No. 660001 and subs. 670001 and subs.
C.3648	Bracket, mounting Silencer at rear	T.73	1	
FS.104/4D	Screw, Set, securing Mounting Bracket to Frame		2	
C.724	Washer, Shakeproof, on Setscrews		2	
C.3659	Pipe, Tail (complete with Mounting Brackets)	T.74	1	Fitted from Chassis No. 660001 to 660058 670001 to 670184
C.4149	Pipe, Tail (complete with Mounting Brackets)		1	Fitted from Chassis No. 660059 to 660983 670185 to 672143
C.6672	Pipe, Tail (complete with Mounting Brackets)		1	Fitted to Chassis No. 660984 and subs. 672144 and subs.
C.5766	Silencer		1	Fitted to Chassis No.
C.5767	Pipe, Tail (complete with Mounting Brackets)		1	669001 and subs. 667001 and subs. 679001 and subs. 677001 and subs.
C.3690	Mounting (Rubber) for suspension of Exhaust System	T.75	3	SUPERSEDED BY C.5062
FN.106/L	Nut on Mountings		6	USED ONLY WITH C.3690
C.726	Washer, Shakeproof, under Nuts		6	
C.5062	Mounting (Rubber) for suspension of Exhaust System		3	SUPERSEDES C.3690
NN.137/L	Nut on Mountings		6	USED ONLY WITH C.5062
C.4155	LINK BRACKET FOR TAIL PIPE SUSPENSION		1	Fitted from Chassis No. 660059 to 660983 670185 to 672143
C.5838	LINK BRACKET FOR TAIL PIPE SUSPENSION		1	Fitted to Chassis No. 660984 and subs. 669001 and subs. 672144 and subs. 679001 and subs. 667001 and subs. 677001 and subs.
NS.137/5D	Screw, Set, securing Link Bracket to Chassis Frame		1	
NN.137/L	Nut on Setscrew		1	
C.726	Washer, Shakeproof, under Nut		1	
EXHAUST SYSTEM (TWIN PIPE RACING TYPE)				FITTED TO SPECIAL EQUIPMENT MODELS (i.e., Cars bearing prefix "S" to Chassis number)
C.5728	Down-Pipe, from Front Manifold to Silencer		1	
C.5729	Down-Pipe, from Rear Manifold to Silencer		1	
C.5198/1	Pipe (Flexible) for Down-Pipes (2$\frac{1}{2}$" i/d \times 9$\frac{1}{2}$" long)		2	
C.495	Gasket, between flanges of Down-Pipes and Manifolds		2	

CHASSIS

Part No.	Description.	Plate No.	No. per Unit.	Remarks.
EXHAUST SYSTEM (continued.)				
(TWIN PIPE RACING TYPE)				
C.5702	Bracket, supporting Down-Pipes		1	
NB.137/6D	Bolt, securing Bracket		1	
NN.137/L	Nut on Bolt		1	
FG.106/X	Washer, Spring, under Nut		1	
C.5062	Mounting (Rubber) for Down-Pipes		2	
NN.137/L	Nut on Mounting		2	
FG.106/X	Washer, Spring, under Nuts		2	
FW.106/T	Washer, Plain, for Mounting		2	
C.5743	Silencer Assembly, complete with Tail Pipes		1	
C.3584	Gasket, between flanges of Silencer and Down-Pipes		2	
NB.137/10D	Bolt, securing Silencer to Down-Pipes		8	
NN.137/L	Nut on Bolts		8	
FG.106/X	Washer, Spring, under Nuts		8	
C.3648	Bracket, supporting rear end of Silencer		1	
FS.104/4D	Screw, Set, securing Bracket		2	
C.724	Washer, Shakeproof, on Setscrews		2	
C.5062	Mounting (Rubber) at rear end of Silencer		1	
NN.137/L	Nut, on Mounting		2	
FG.106/X	Washer, Spring, under Nuts		2	
FW.106/T	Washer, Plain, for Mounting		1	
C.5707	Bracket for Tail Pipe suspension		1	
NB.125/7D	Bolt, securing Bracket to Body		2	
NN.125/L	Nut on Bolts		2	
FG.104/X	Washer, Spring, under Nuts		2	
BD.4987	Pad (Rubber) for Tail Pipe mounting		2	
C.3052	Washer (Special) for top Pad		1	
NB.137/10D	Bolt, securing Tail Pipes to Bracket		1	
NN.137/L	Nut on Bolt		1	
FG.106/X	Washer, Spring, under Nut		1	
C.5743	SILENCER AND TAIL PIPES ASSEMBLY (TWIN PIPE RACING TYPE)		1	
C.5197	Silencer, Exhaust		1	
C.5200	Tail-Pipe		2	
C.3618	PETROL TANK ASSEMBLY	T.76	1	Fitted from Chassis No. 660001 to 660058 670001 to 670184
C.3618/1	PETROL TANK ASSEMBLY		1	Fitted to Chassis No. 660059 and subs. 669001 and subs. 670185 and subs. 679001 and subs.
C.2779	Element Unit for Petrol Tank	T.77	1	
C.937	Gasket for Element Unit	T.78	1	
AS.303/4H	Screw, securing Element Unit		6	
C.2296/6	Washer (Copper) on Screws		6	
C.990	Filter Assembly	T.79	1	
C.1617	Gasket for Filter Assembly	T.80	1	
C.3668	Filler Spout	T.81	1	
C.3735	Pipe, Air Vent	T.82	1	Fitted from Chassis No. 660001 to 660058 670001 to 670184
C.6765	PETROL TANK ASSEMBLY		1	
C.990	Filter Assembly		1	FITTED TO DROP HEAD COUPE MODELS ONLY
C.1617	Gasket for Filter		1	
C.6804	Filler Spout		1	
C.7894	Pipe, Air Vent		1	
C.2779	Element Unit for Petrol Tank		1	
C.937	Gasket for Element Unit		1	

NOTE.—Petrol Tanks C.3618, C.3618/1 or C.6765 are not required when Auxiliary Tank is fitted (see page 95A).

CHASSIS

Part No.	Description.	Plate No.	No. per Unit.	Remarks.
C.4198	Tray Assy., holding Petrol Tank		1	Fitted to Chassis No. 660059 and subs. 667001 and subs. 670185 and subs. 677001 and subs. 669001 and subs. 679001 and subs.
C.4158	Rod, Tie (Long) securing Petrol Tank at rear		2	
C.4159	Rod, Tie (Short) securing Petrol Tank at front		2	
NN.131/L	Nut on Tie Rods		8	
NN.231/L	Nut, Lock, on Tie Rods		6	
C.4161	Felt (32" x 4") for Petrol Tank Mounting		1	
C.4162	Felt (27" x 1 1/2") for Petrol Tank Mounting		1	
C.4163	Felt (18" x 1 1/2") for Petrol Tank Mounting		2	
C.4164	Felt (12" x 1 1/2") for Petrol Tank Mounting		5	
C.4199	Felt (6" x 2 1/2") for Petrol Tank Mounting		2	
BD.4368	PETROL FILLER HOSE (FROM FILLER BOX TO TANK)		1	
	PETROL PIPES			
C.3692	Pipe Assembly, Rear	T.83	1	
C.3693	Pipe Assembly, Centre	T.84	1	
C.3694	Pipe Assembly, Front	T.85	1	
C.3727	Clip, securing Petrol Pipes to Chassis Frame	T.86	5	
C.1040/7	Clip, securing Front Petrol Pipe to Dash		1	
AS.402/4H	Screw, Set, securing Clip to Dash		1	
AN.102/L	Nut on Setscrew		1	
C.723	Washer, Shakeproof, under Nut		1	
C.3463	RADIATOR BLOCK ASSEMBLY	T.87	1	Fitted from Chassis No. 660001 to 660028 670001 to 670070 also 670075
C.3463/1	RADIATOR BLOCK ASSEMBLY		1	Fitted to Chassis No. 660029 to 660214 670071 to 670074 670076 to 670682
C.3463/2	RADIATOR BLOCK ASSEMBLY		1	Fitted to Chassis No. 660215 and subs. 669001 and subs. 670683 and subs. 679001 and subs. 667001 and subs. 677001 and subs.
C.3455	Cap, Filler	T.88	1	
C.3521	Washer for Filler Cap	T.89	1	
C.980	Tap, Drain	T.90	1	
C.981	Washer (Fibre) on Drain Tap	T.91	1	
C.3718	Packing (Rubber) between bottom of Radiator and Chassis Frame	T.92	4	
C.3464	TIE ROD, HOLDING DOWN RADIATOR	T.93	2	Fitted to Chassis No. 660001 and subs. 677001 and subs. 670001 and subs. 679001 and subs.
C.6793	TIE ROD, HOLDING DOWN RADIATOR		2	Fitted to Chassis No. 669001 and subs. 667001 and subs.
NN.131/L	Nut, securing Tie Rods to Brackets on Radiator	T.94	2	
C.725	Washer, Shakeproof, under Nuts	T.95	2	
L.103/7U	Pin, Split, securing Tie Rods to Brackets on Chassis Frame	T.96	2	
C.3465	TIE ROD, FROM RADIATOR TO BRACKETS ON CHASSIS SIDE-MEMBERS	T.97	2	
552	Eye-End for Tie Rods	T.98	2	

CHASSIS

Part No.	Description.	Plate No.	No. per Unit.	Remarks.
NB.131/7D	Bolt, through Eye-End, securing Tie Rods to Radiator	T.99	2	
NN.131/L	Nut on Bolts	T.100	2	
C.725	Washer, Shakeproof, under Nuts	T.101	2	
NN.137/L	Nut, securing Tie Rods to Brackets on Chassis Side Members	T.102	4	
C.726	Washer, Shakeproof, under bottom Nuts	T.103	2	
C.725	Washer, Shakeproof, under top Nuts	T.104	2	
C.3674	TOP WATER HOSE	T.105	1	Fitted from Chassis No. 660001 to 660227 670001 to 670774
C.3675	BOTTOM WATER HOSE	T.106	1	Fitted from Chassis No. 660001 to 660214 670001 to 670682
C.6809	TOP WATER HOSE		1	Fitted to Chassis No. 660228 and subs. 679001 and subs. 669001 and subs. 670775 and subs. 667001 and subs. 677001 and subs.
C.4183	BOTTOM WATER HOSE		1	Fitted from Chassis No. 660215 and subs. 670683 and subs. 669001 and subs. 679001 and subs. 667001 and subs. 677001 and subs.
C.3676	BY-PASS WATER HOSE	T.107	1	
C.2905/2	Clip, securing By-Pass Hose to Water Pump	T.108	1	
C.2905/3	Clip, securing By-Pass Hose to Thermostat Housing	T.109	1	
C.2905/4	Clip, securing Top Water Hose	T.110	2	
C.2905/5	Clip, securing Bottom Water Hose	T.111	2	
C.3731	THERMOSTAT (SMITH X.43655)	T.112	1	
C.3732	HOUSING FOR THERMOSTAT	T.113	1	
C.3344	Gasket, between Thermostat Housing and Radiator	T.114	1	
NN.131/L	Nut, securing Thermostat Housing to Radiator	T.115	2	
C.725	Washer, Shakeproof, under Nuts	T.116	2	
C.3961	SPARE WHEEL TRAY	T.117	1	Fitted from Chassis No. 660001 to 660058 670001 to 670184
C.3860	Strap, retaining Spare Wheel in Tray	T.118	1	
C.3863	Hook, engaging top of Strap	T.119	1	
C.3864	Nut on Hook	T.120	1	
BD.4172	SPARE WHEEL TRAY		1	Fitted to Chassis No. 660059 and subs. 669001 and subs. 670185 and subs. 679001 and subs. 667001 and subs. 677001 and subs.
BD.4518	Bracket, on Cross Rail, for Spare Wheel Clamp		1	
BD.4520	Hinge-Pin Assy., for Spare Wheel Clamp		1	
BD.4515	Clamp Assy., holding Spare Wheel		1	
C.3864	Nut for Clamp		1	

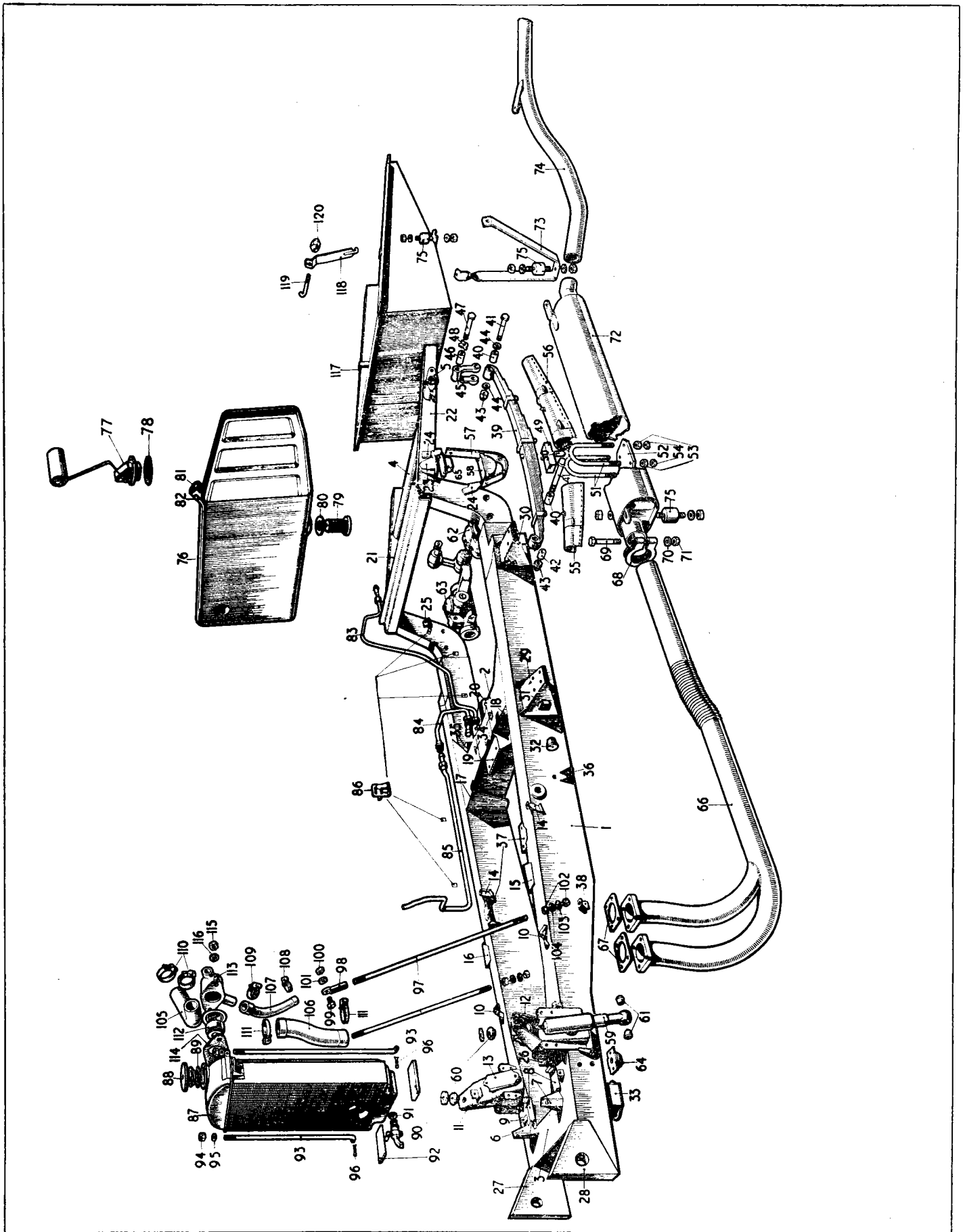

PLATE T.